

kvik 

MC696,060

Method 1 (Thermex)
Method 2 (Siemens/Bosch)

DC96,060,000

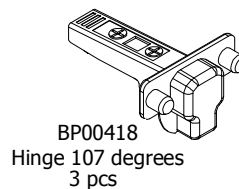
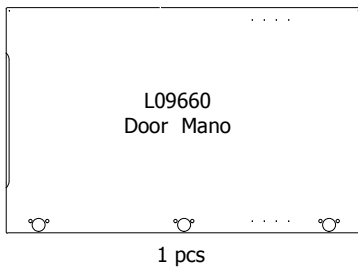
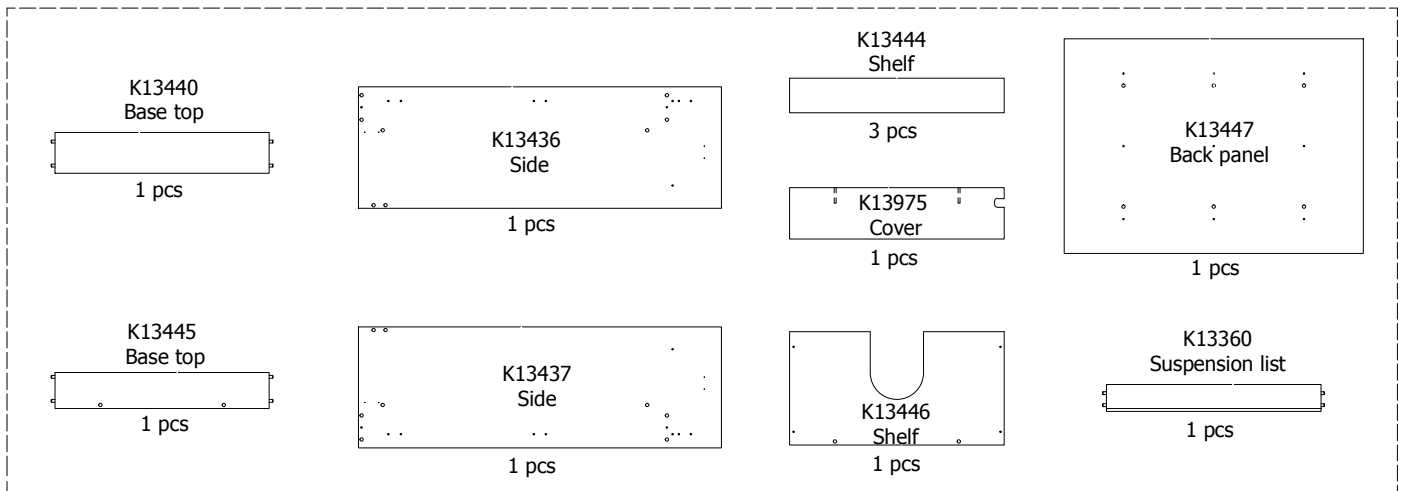

BP00029

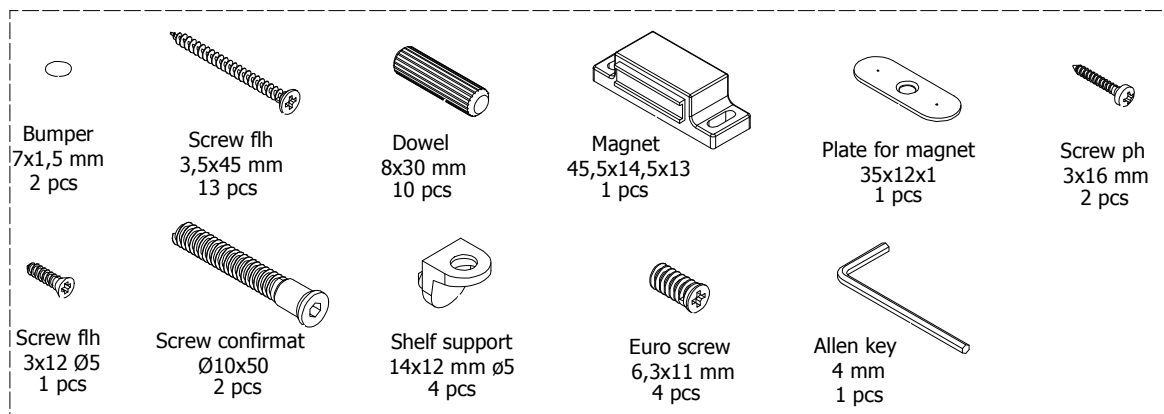

FIG. 1

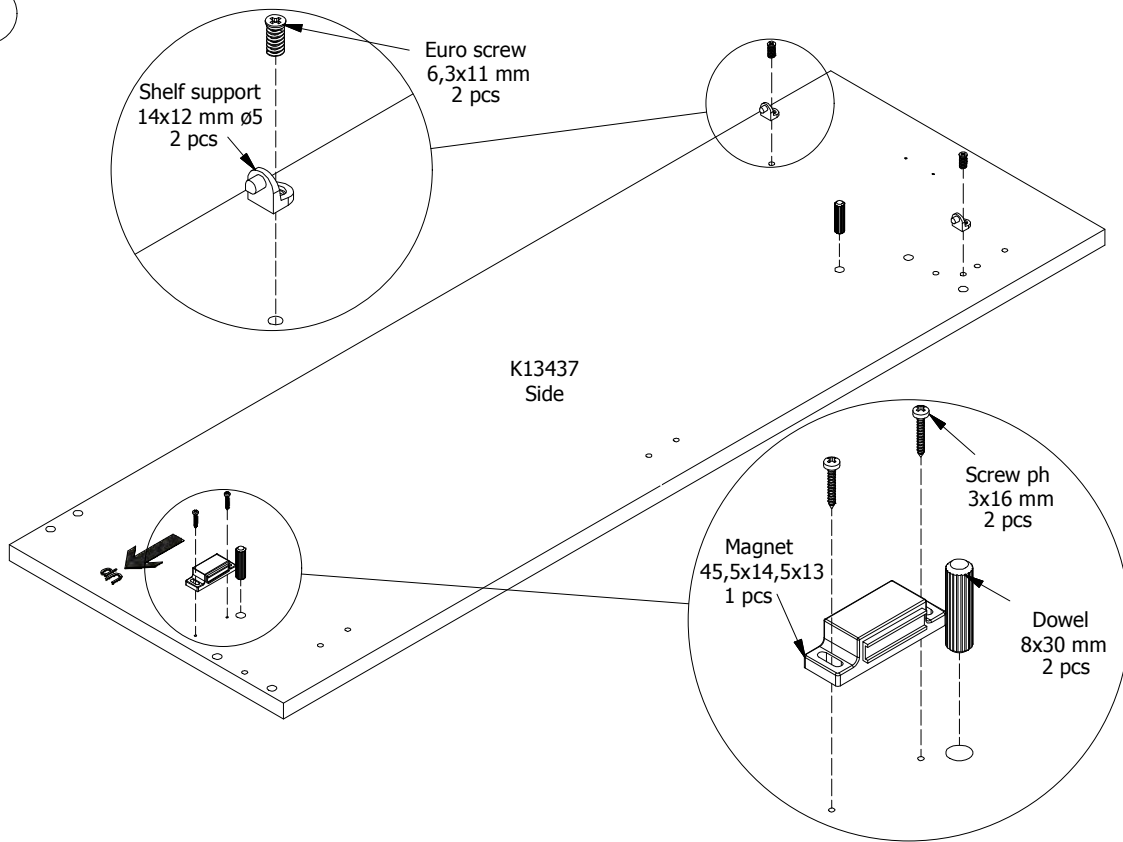

FIG. 2

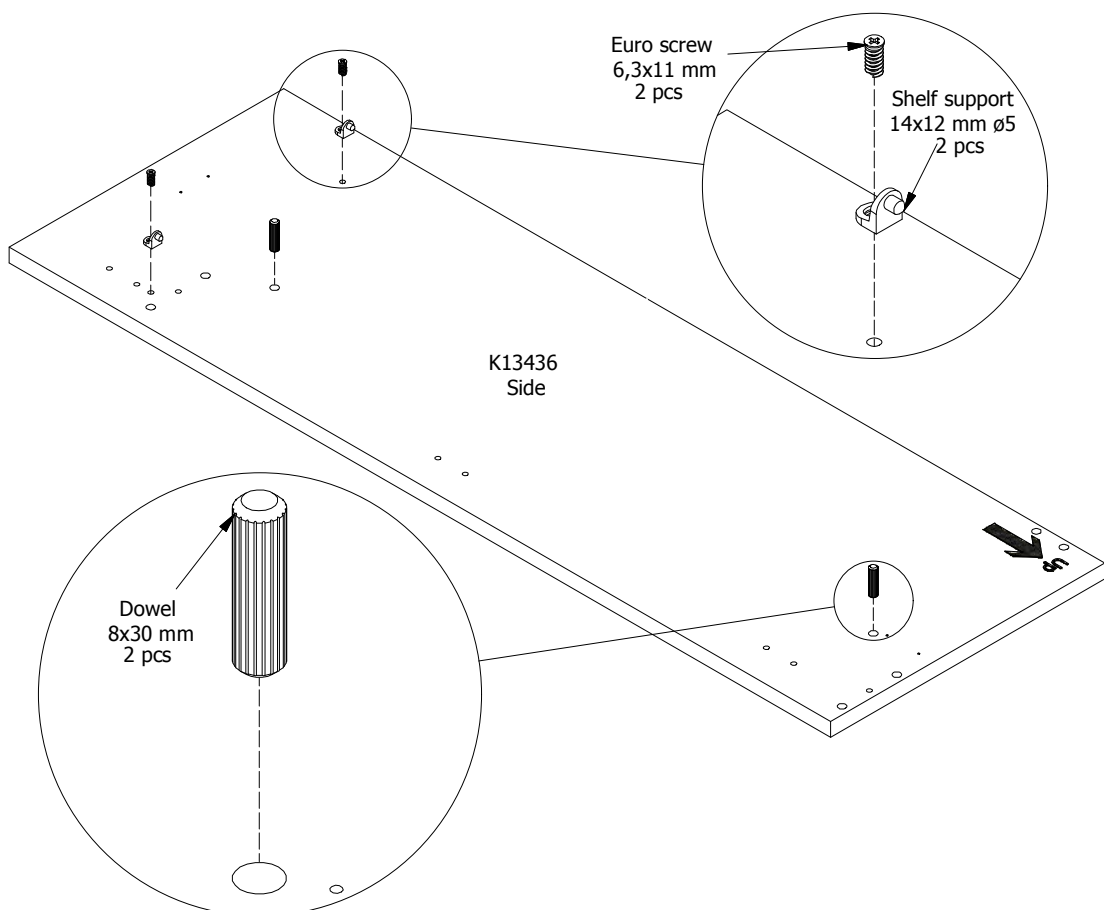

FIG. 3

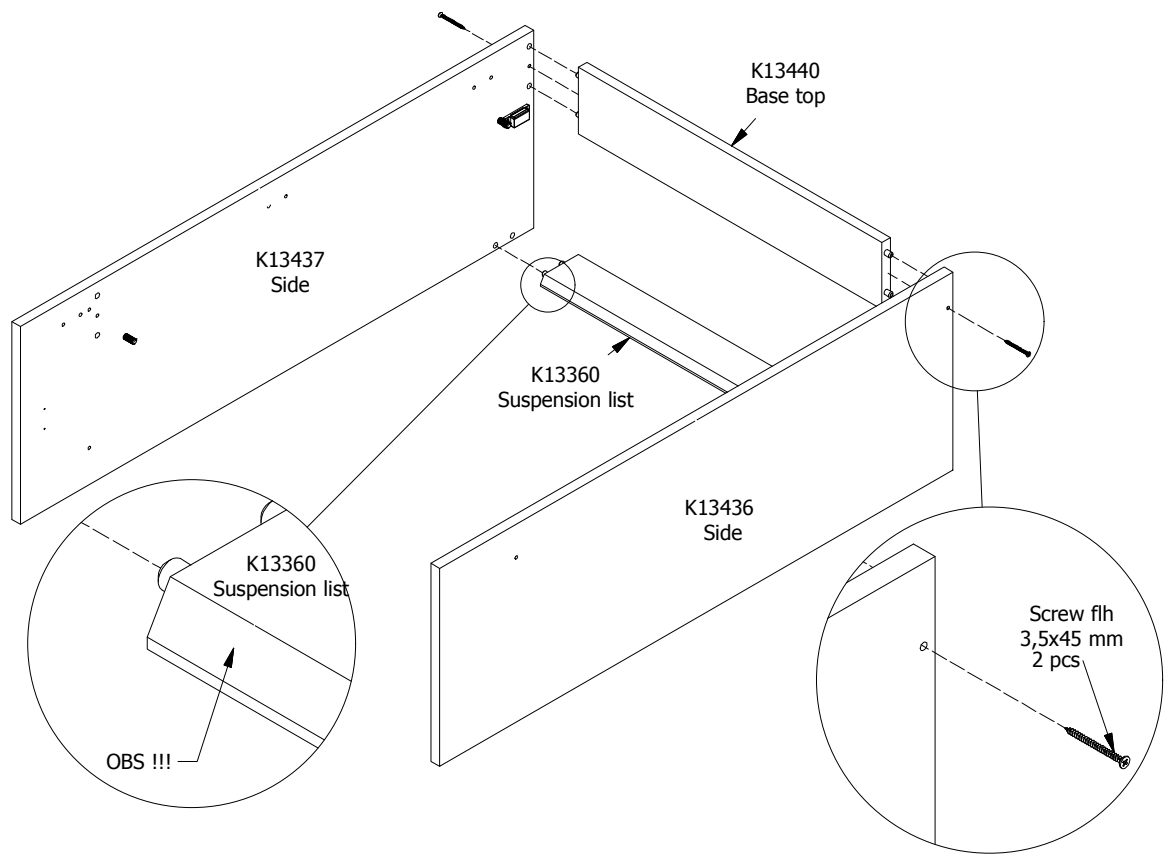

FIG. 4

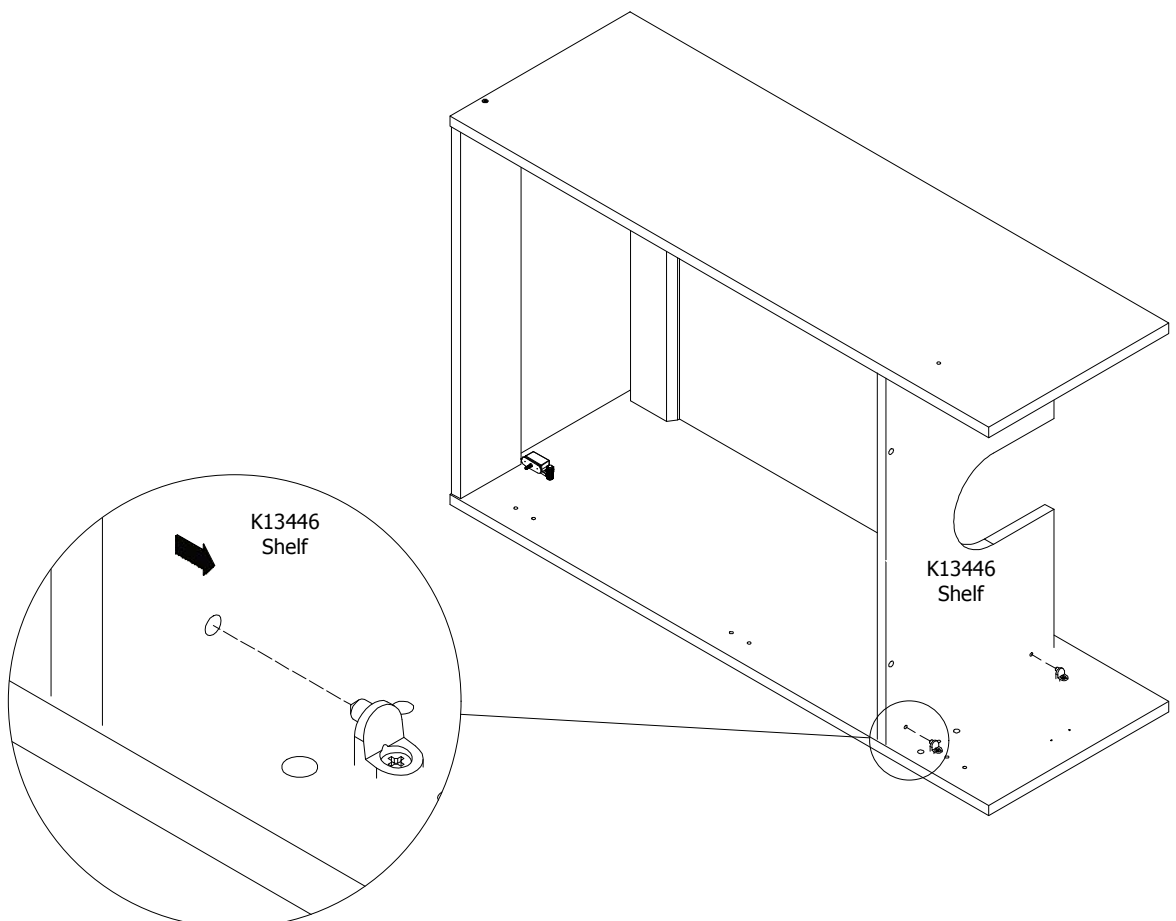

FIG. 5

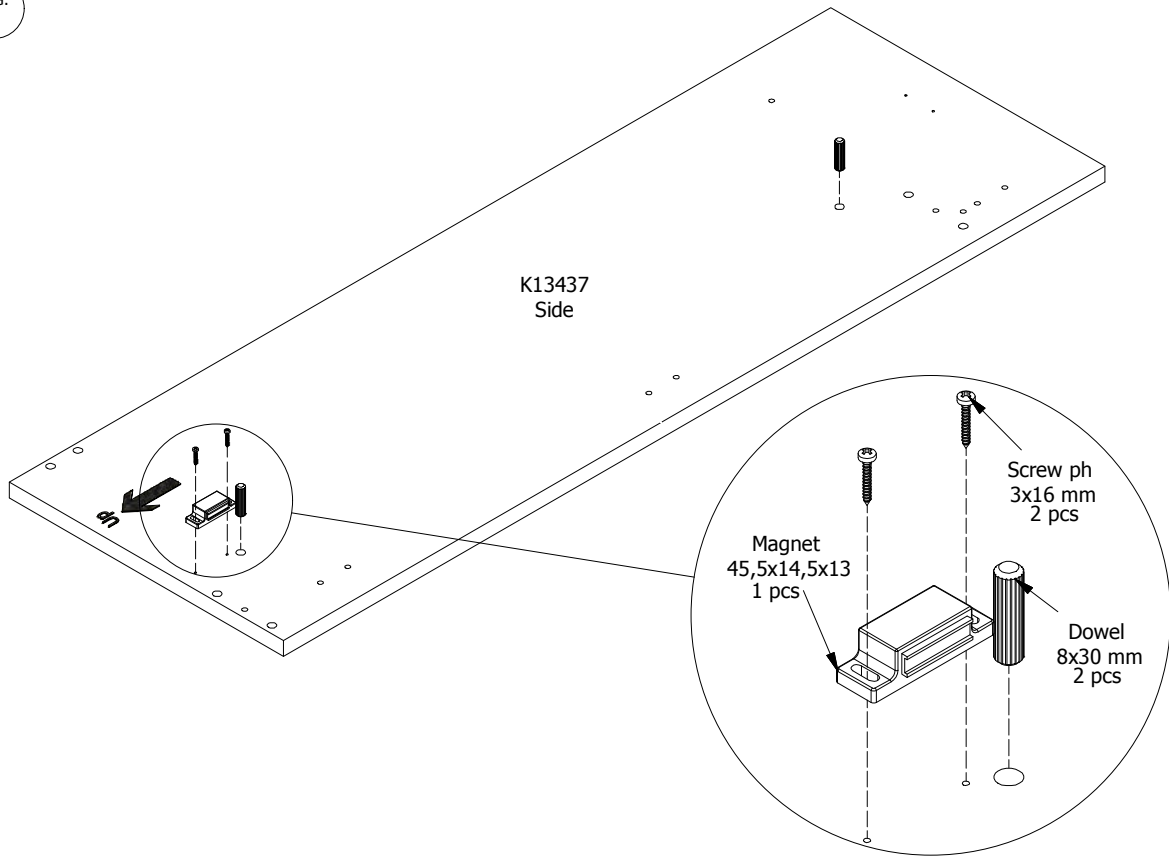

FIG. 6

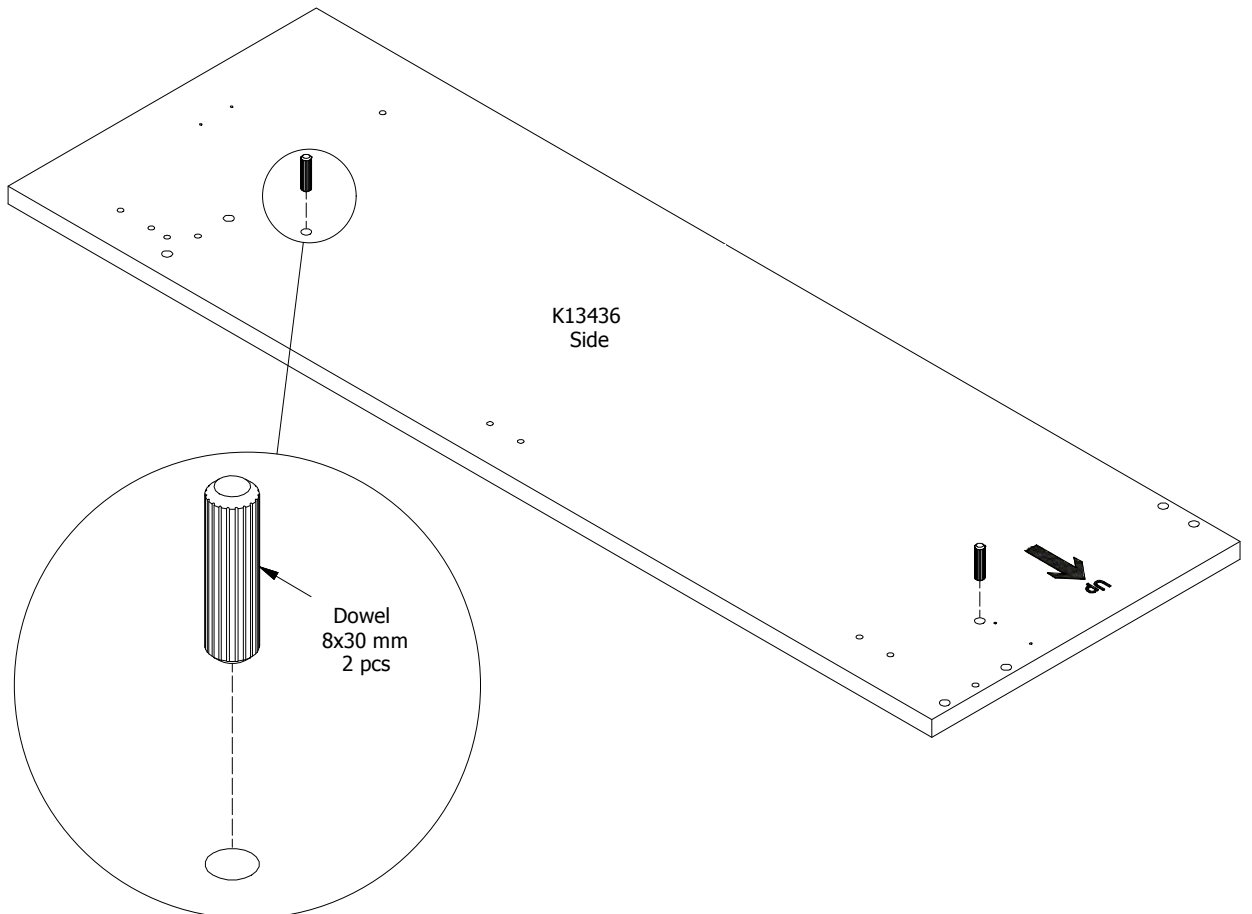

FIG. 7

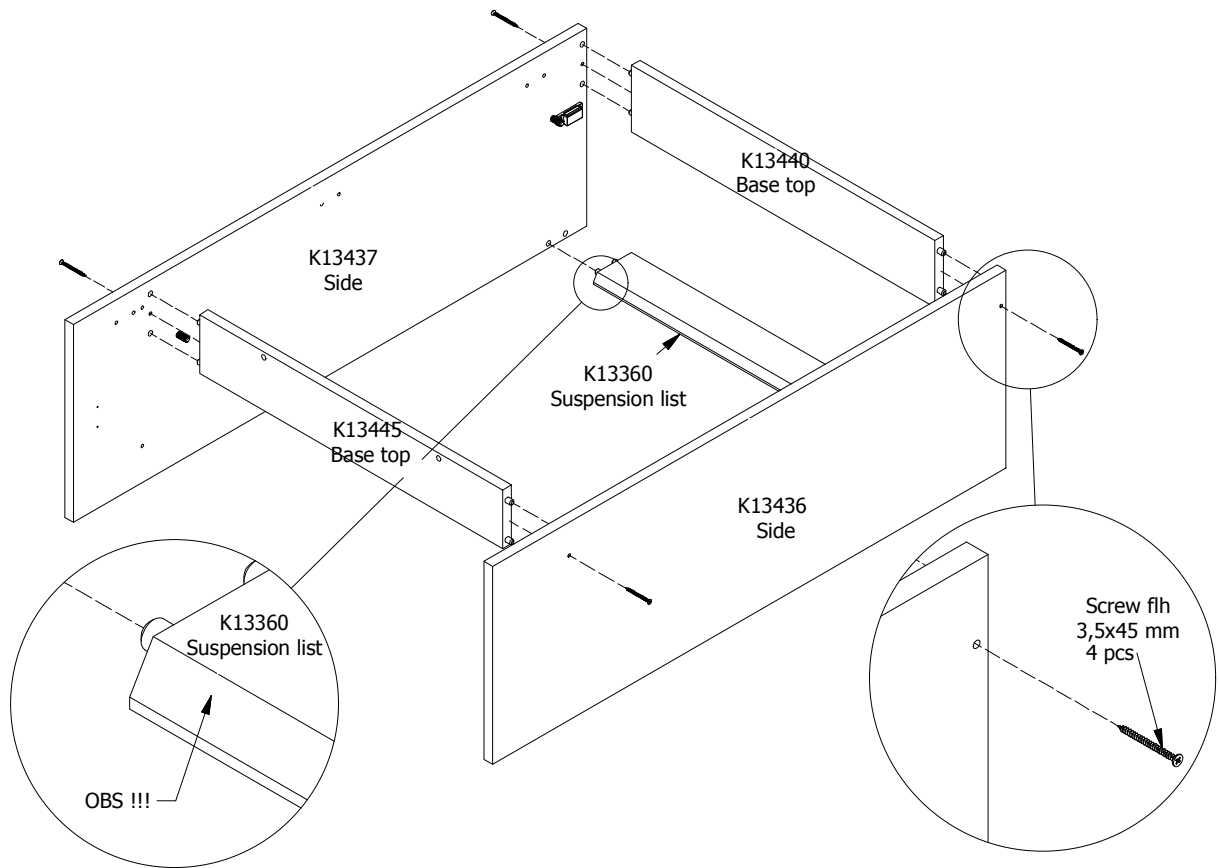

FIG. 8

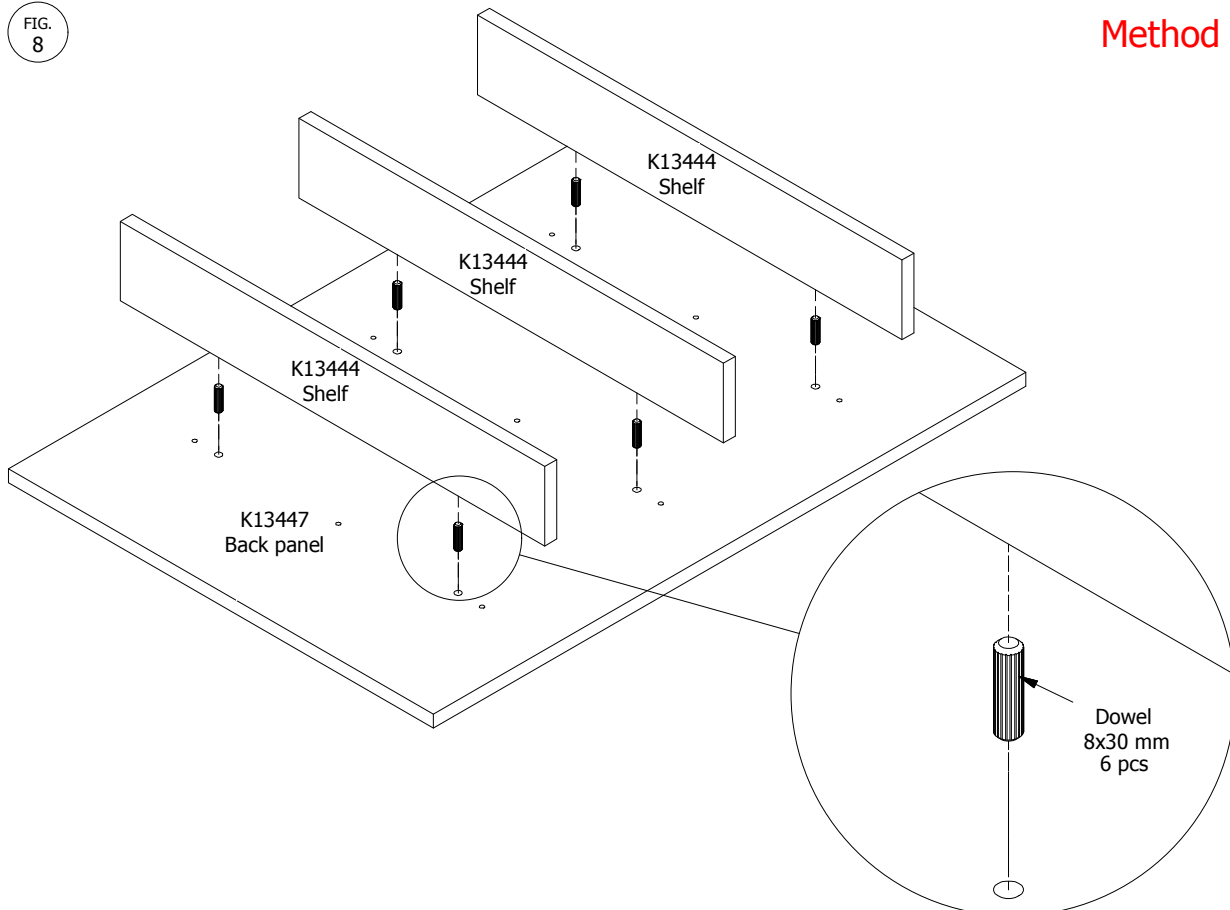

FIG. 9

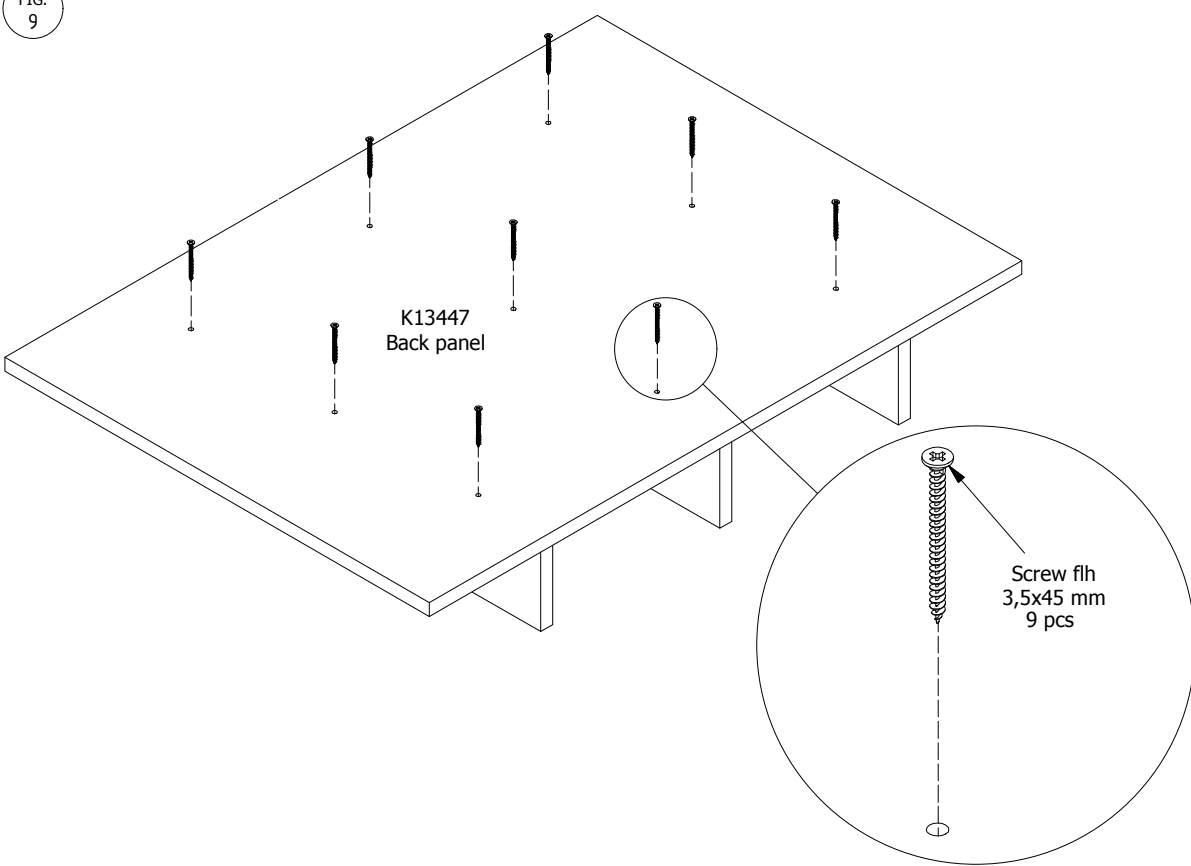

FIG. 10

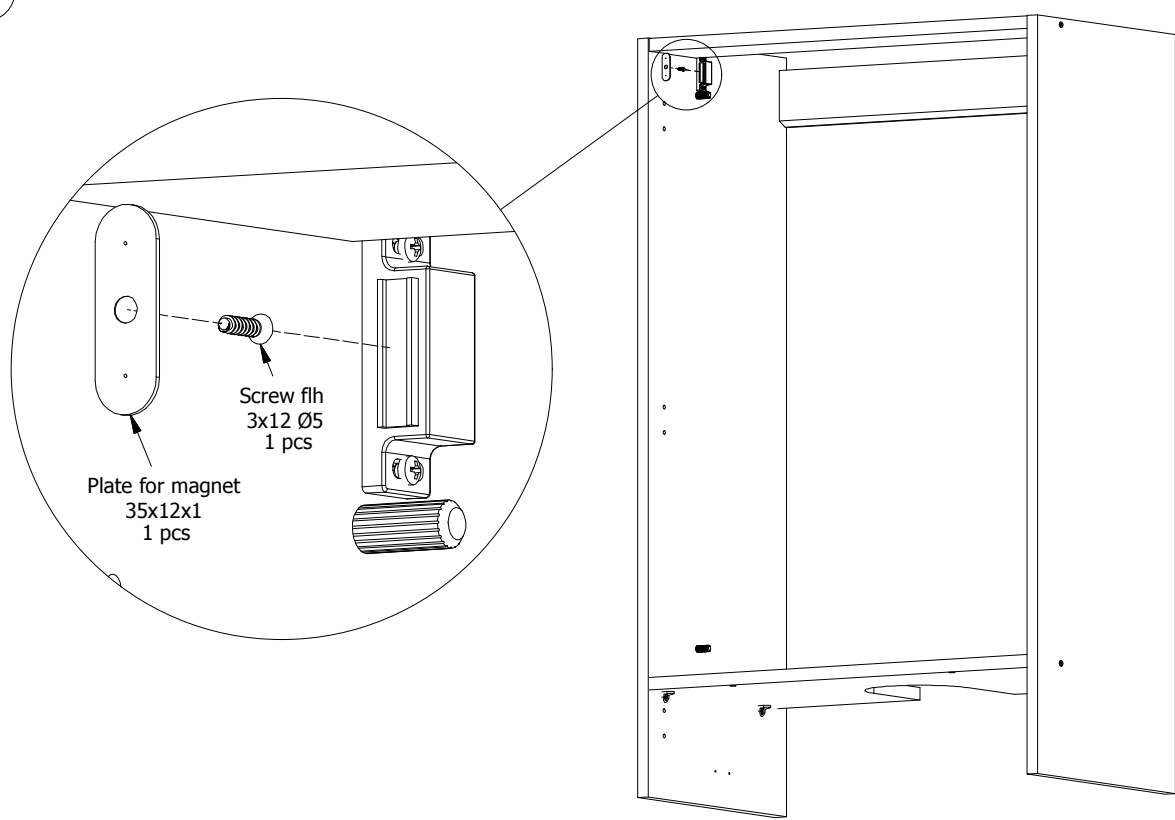
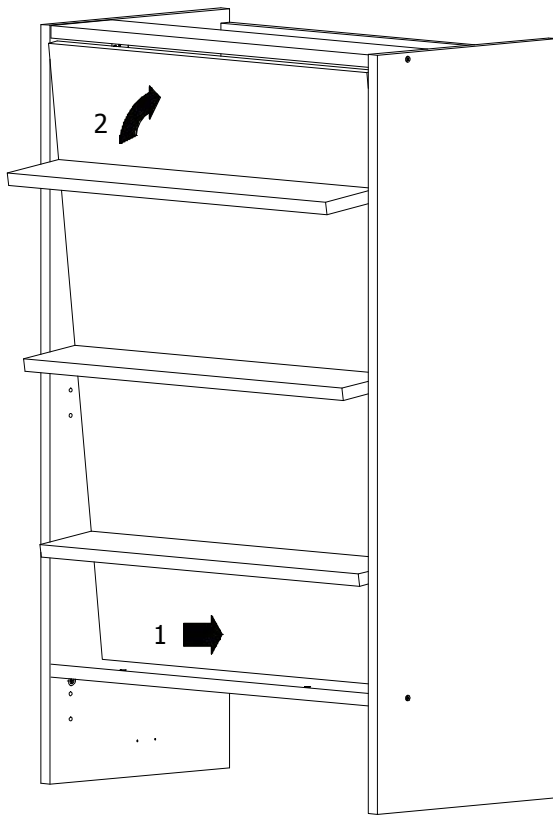

FIG. 11



Push, and the screw will make a mark on the backside, to use to mount the plate for magnet

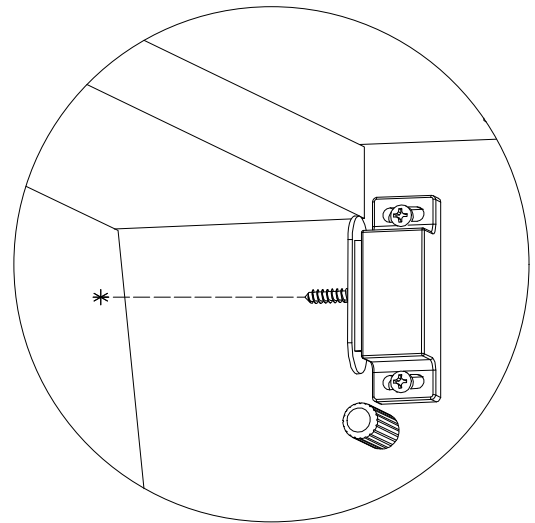

FIG. 12

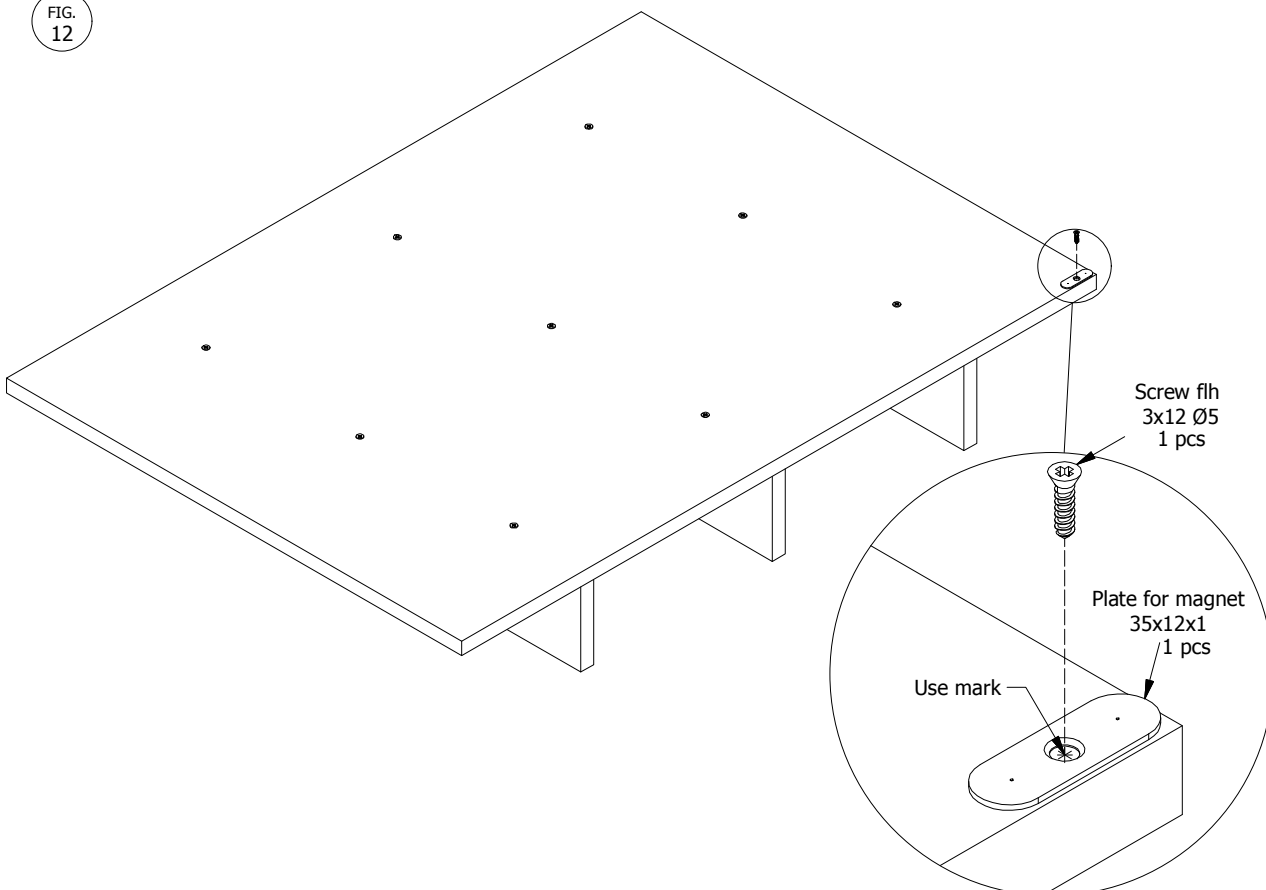

FIG. 13

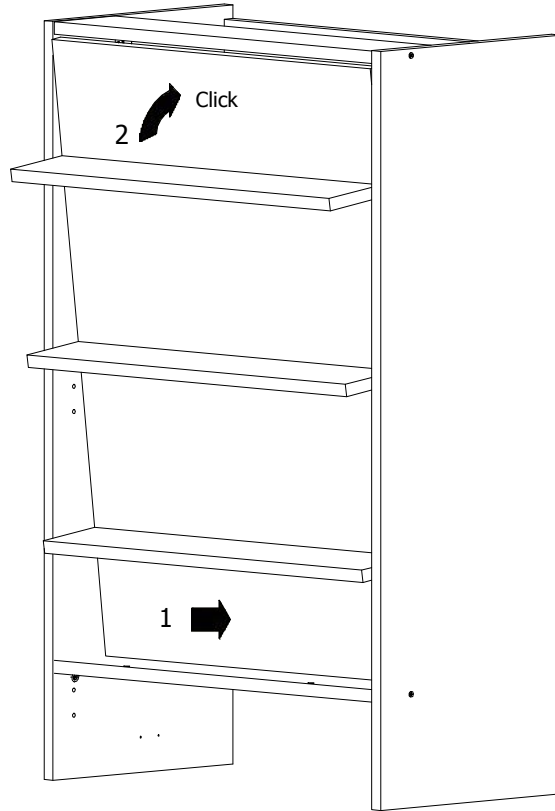

Fig 14

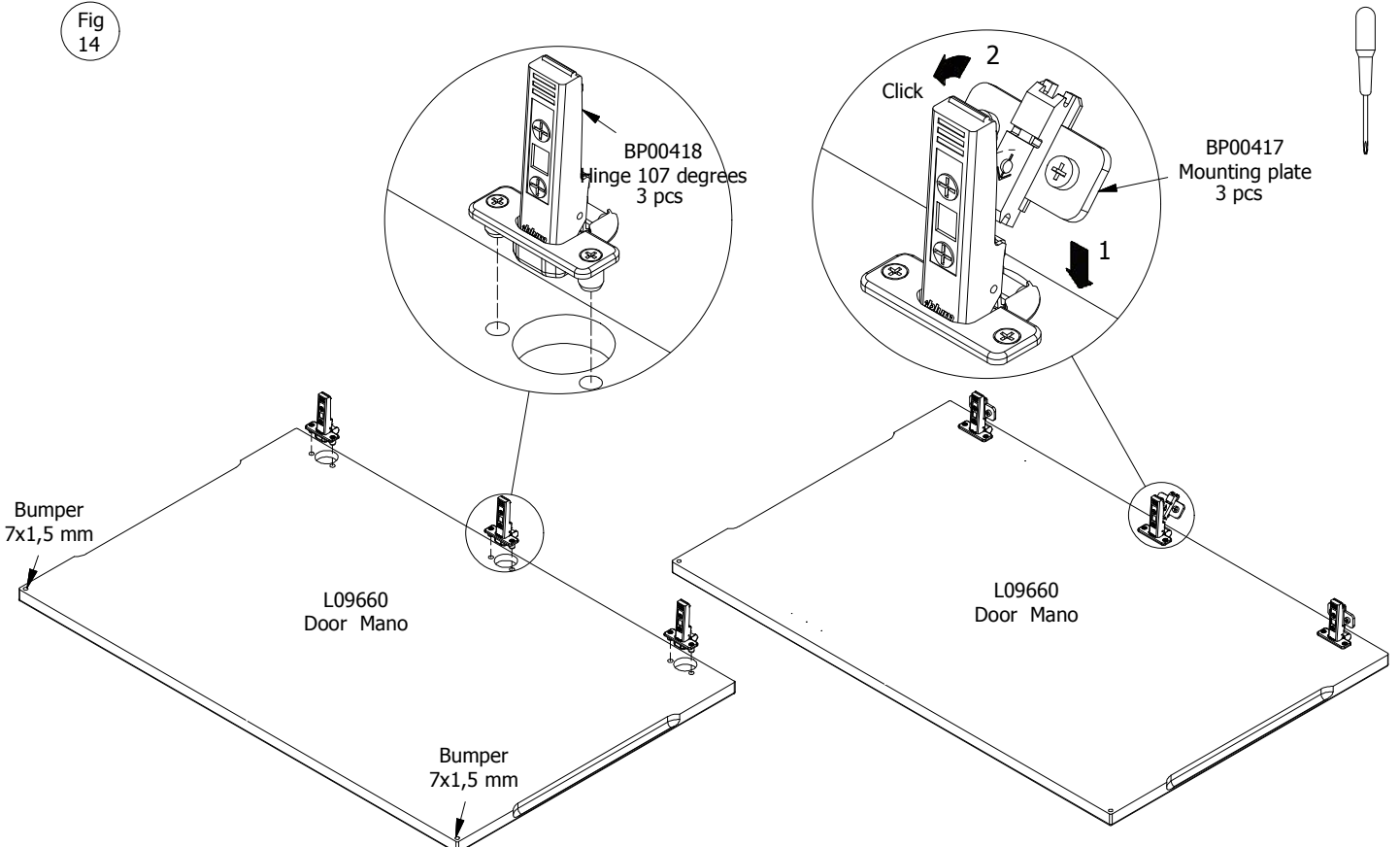

Fig 15

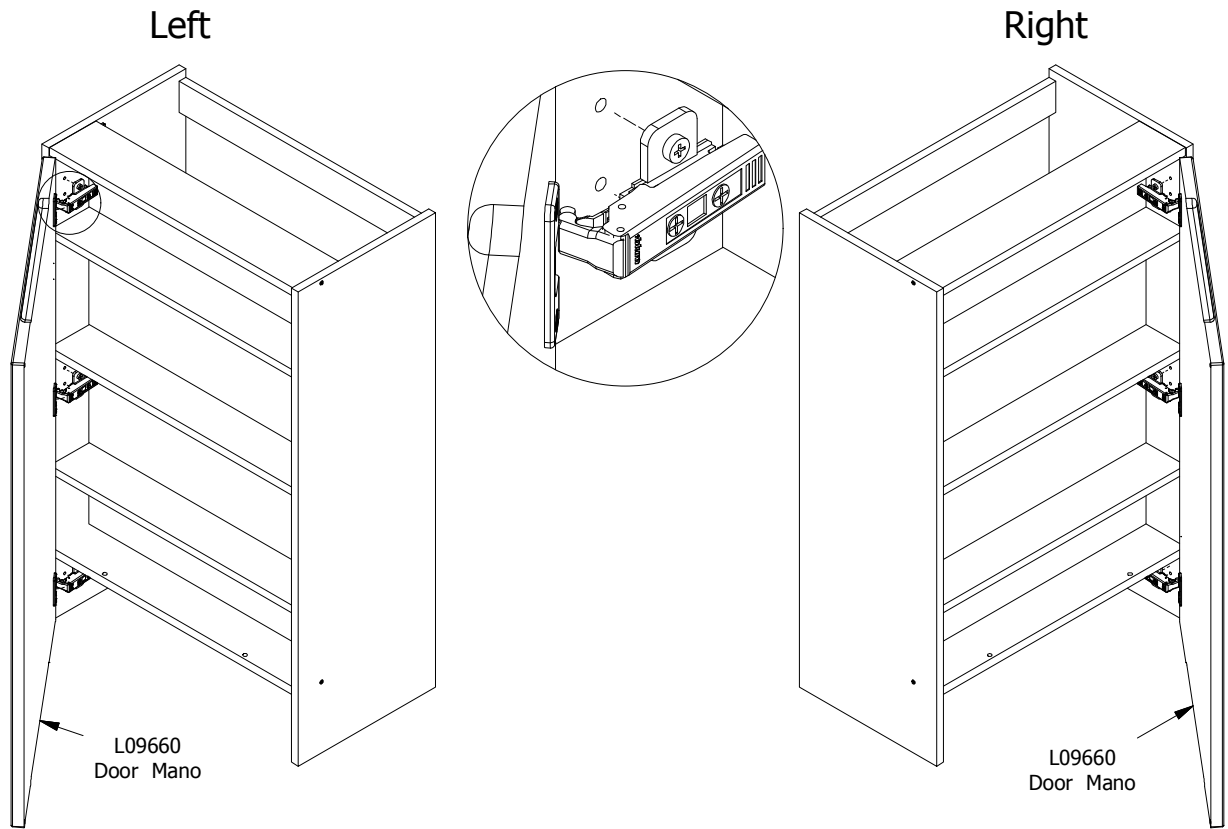

Fig 16

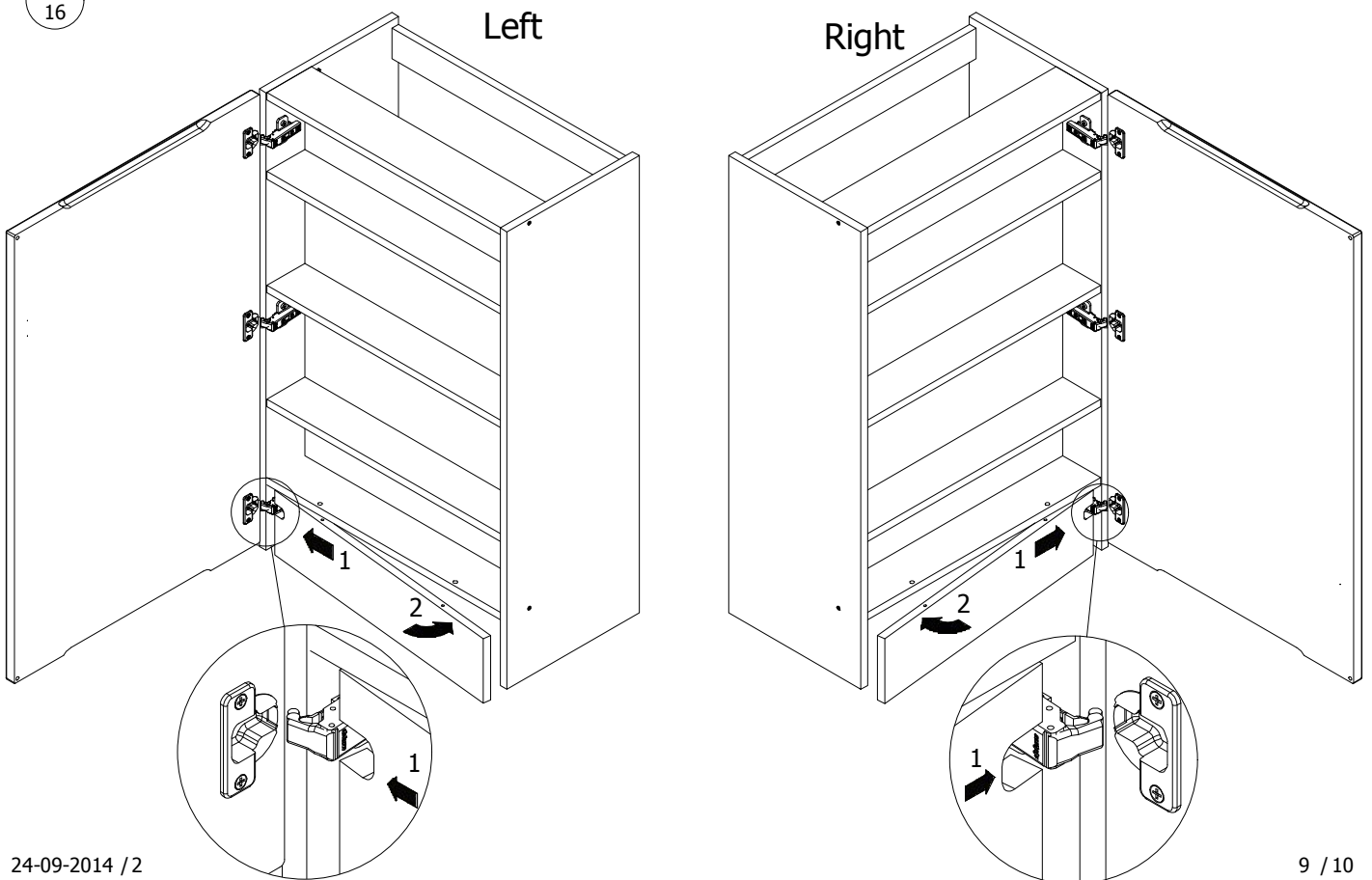
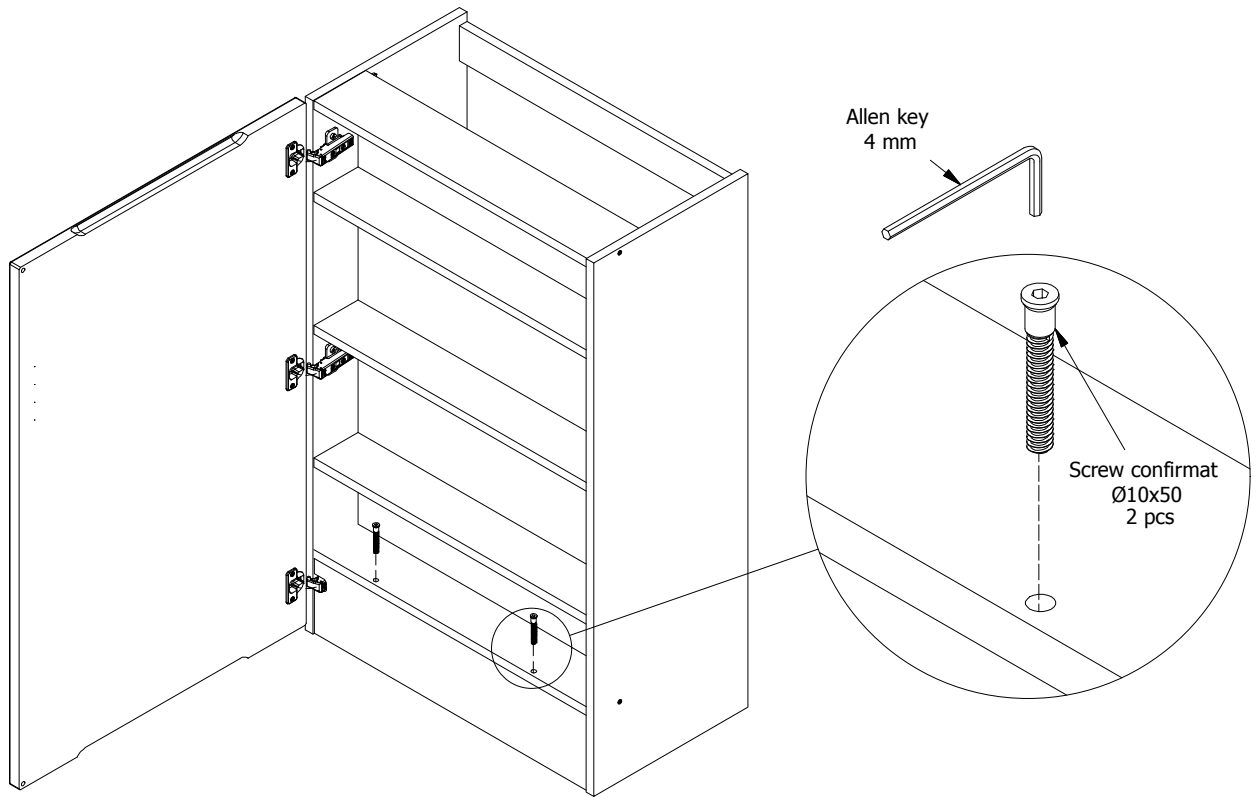

Fig 17



Adjustment

