

kvik 

C696,060

Method 1 (Thermex)
Method 2 (Siemens)

DC96,060,000

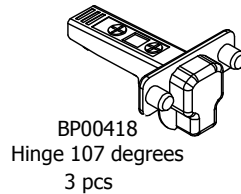
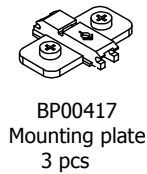
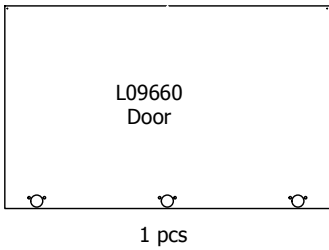
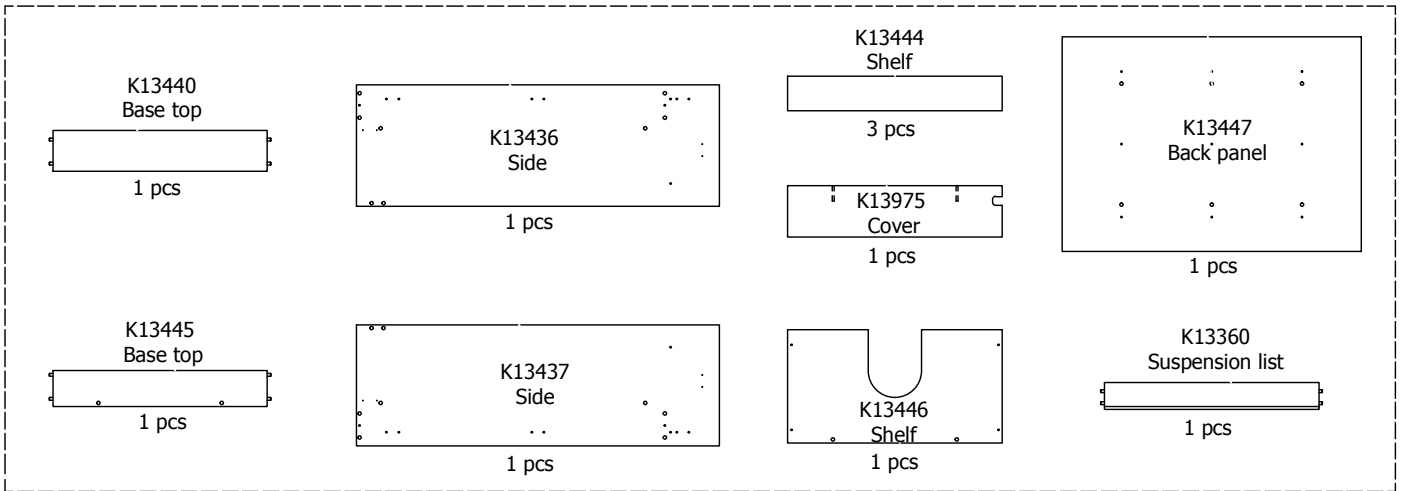

BP00029-BP00250

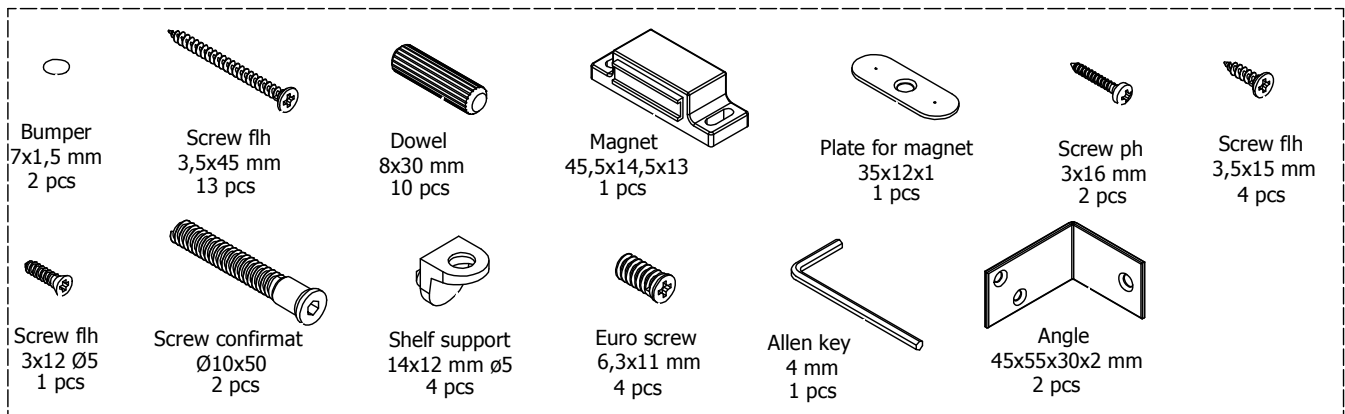

FIG. 1

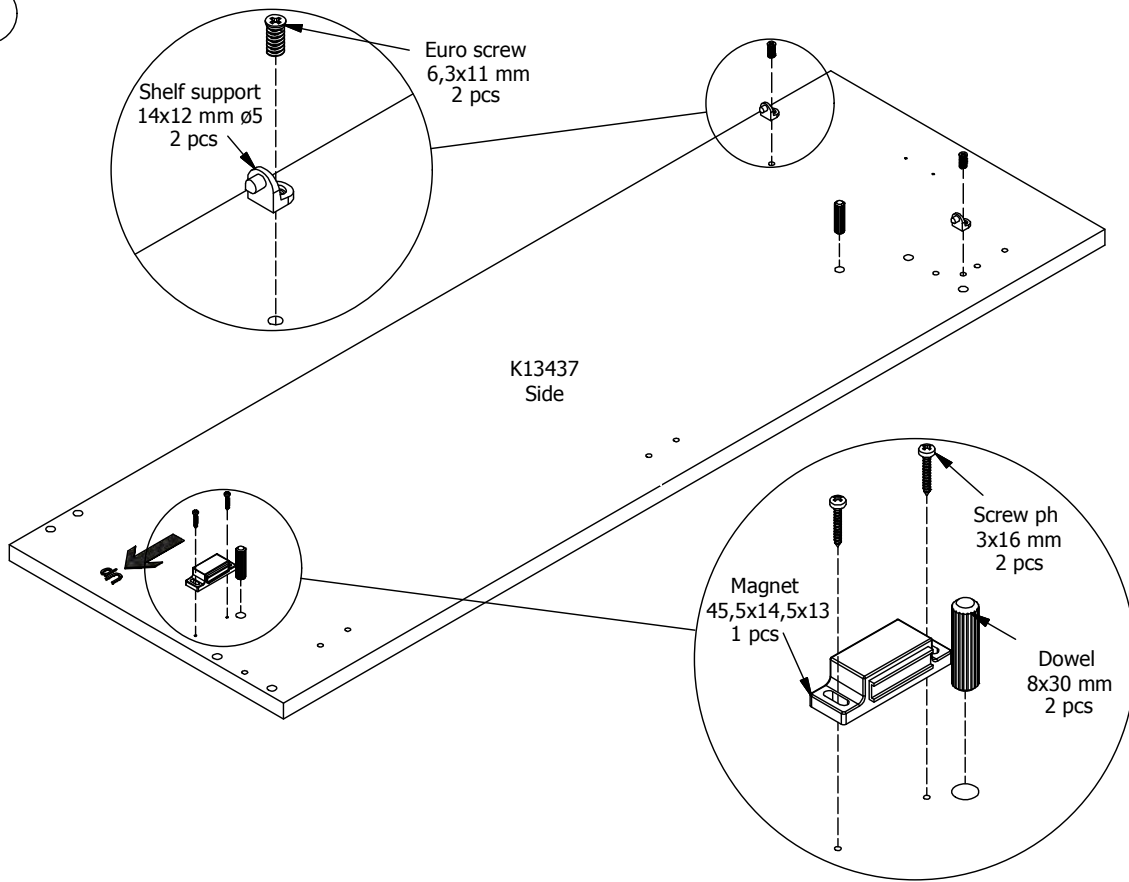

FIG. 2

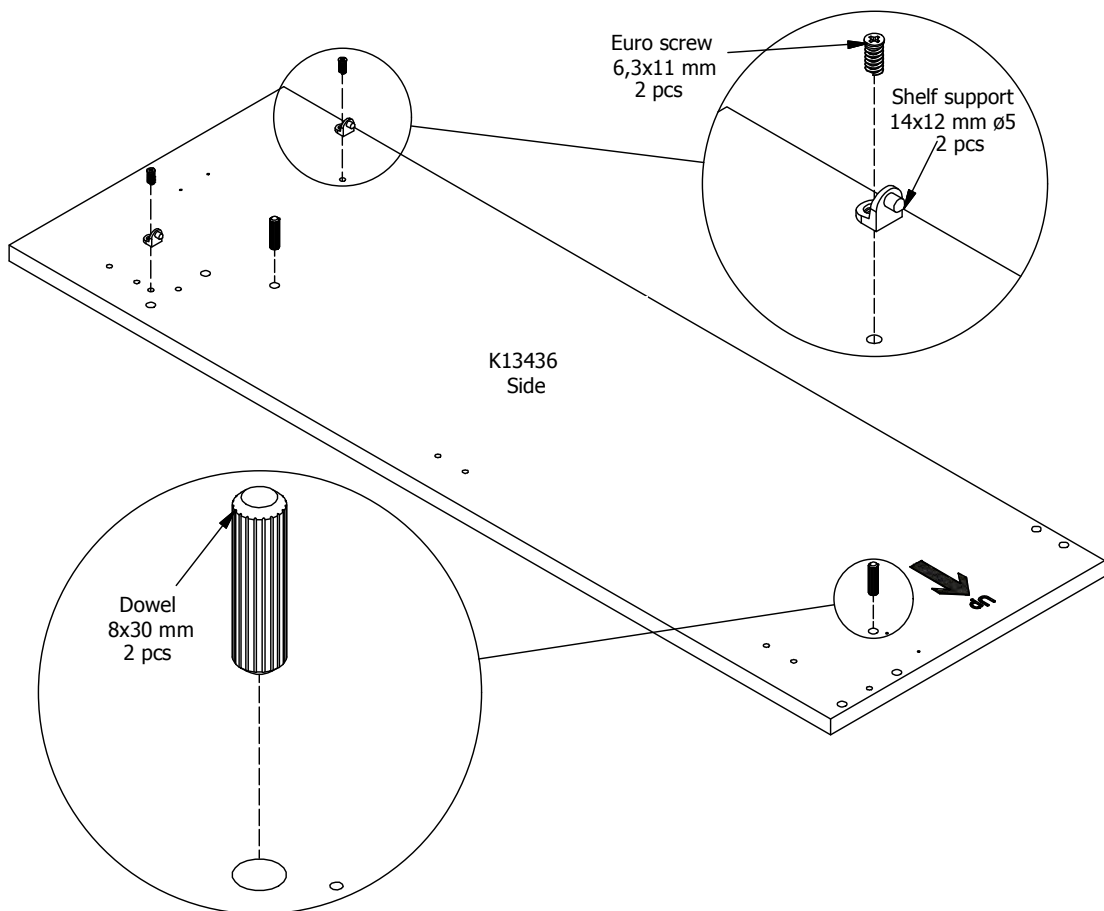

FIG. 3

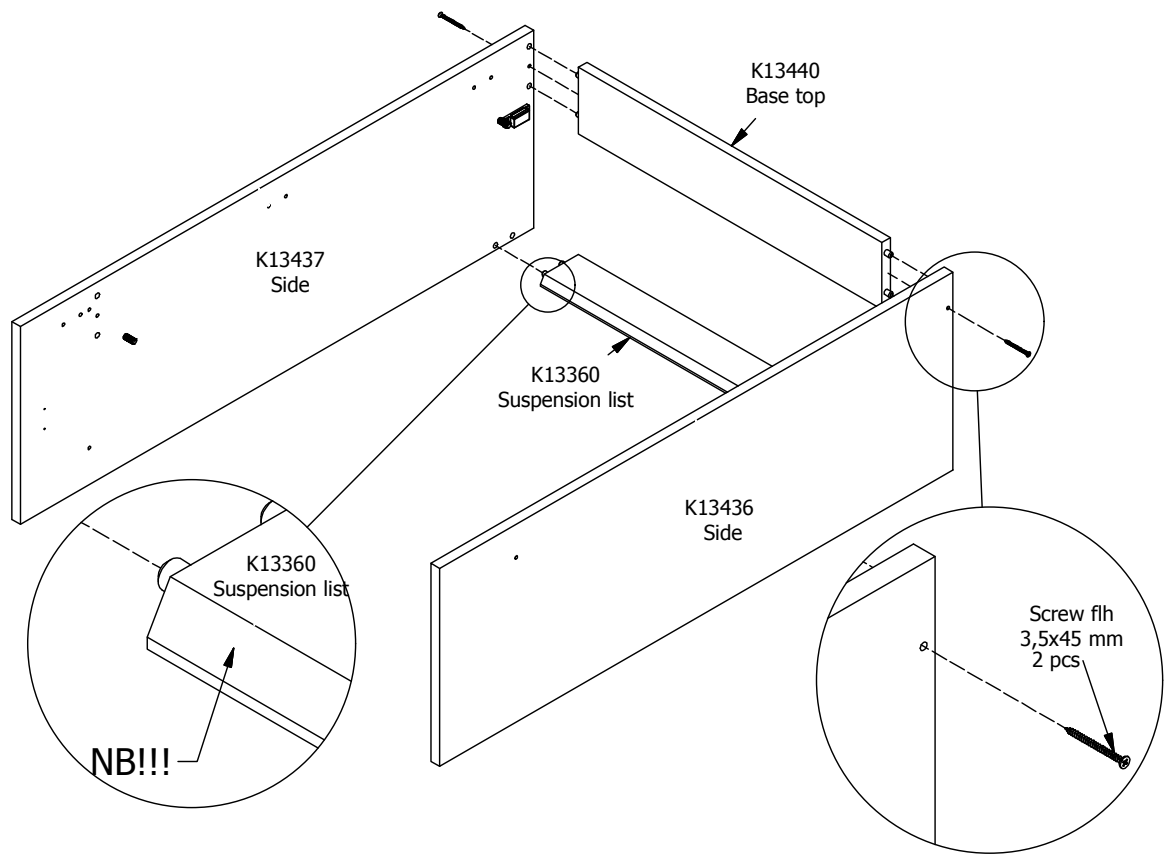

FIG. 4

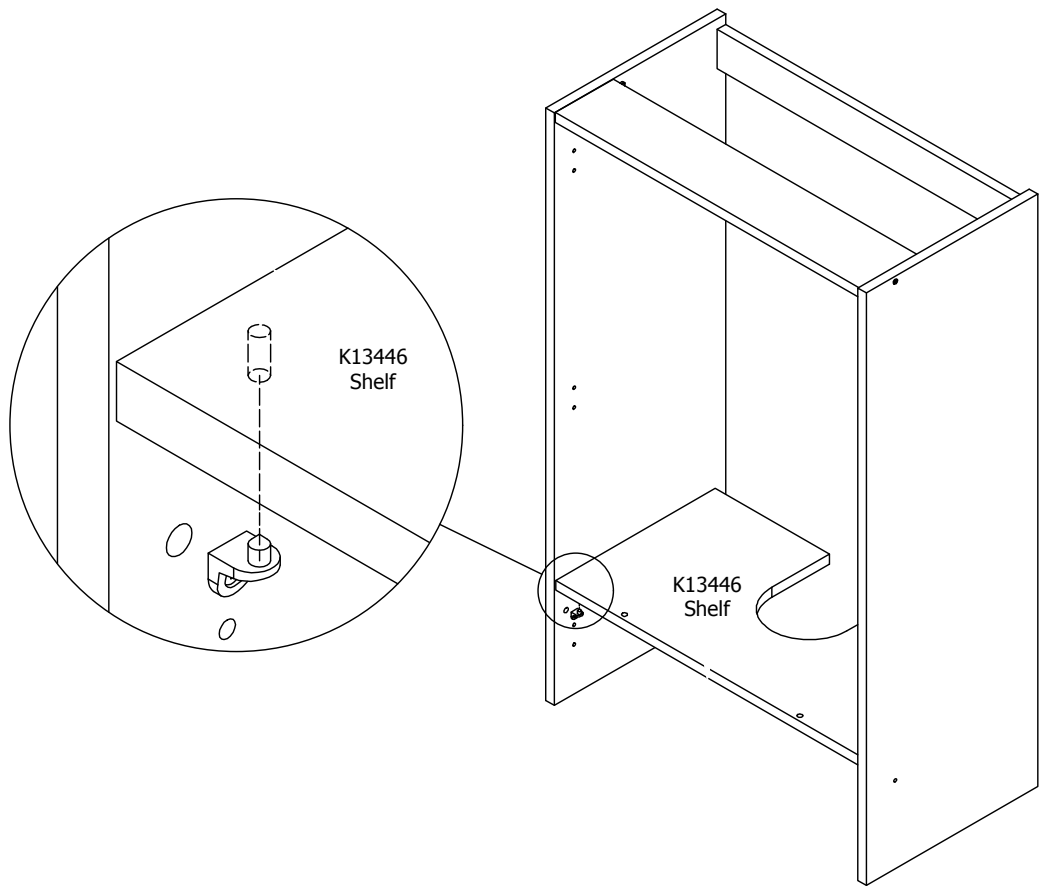

FIG. 5

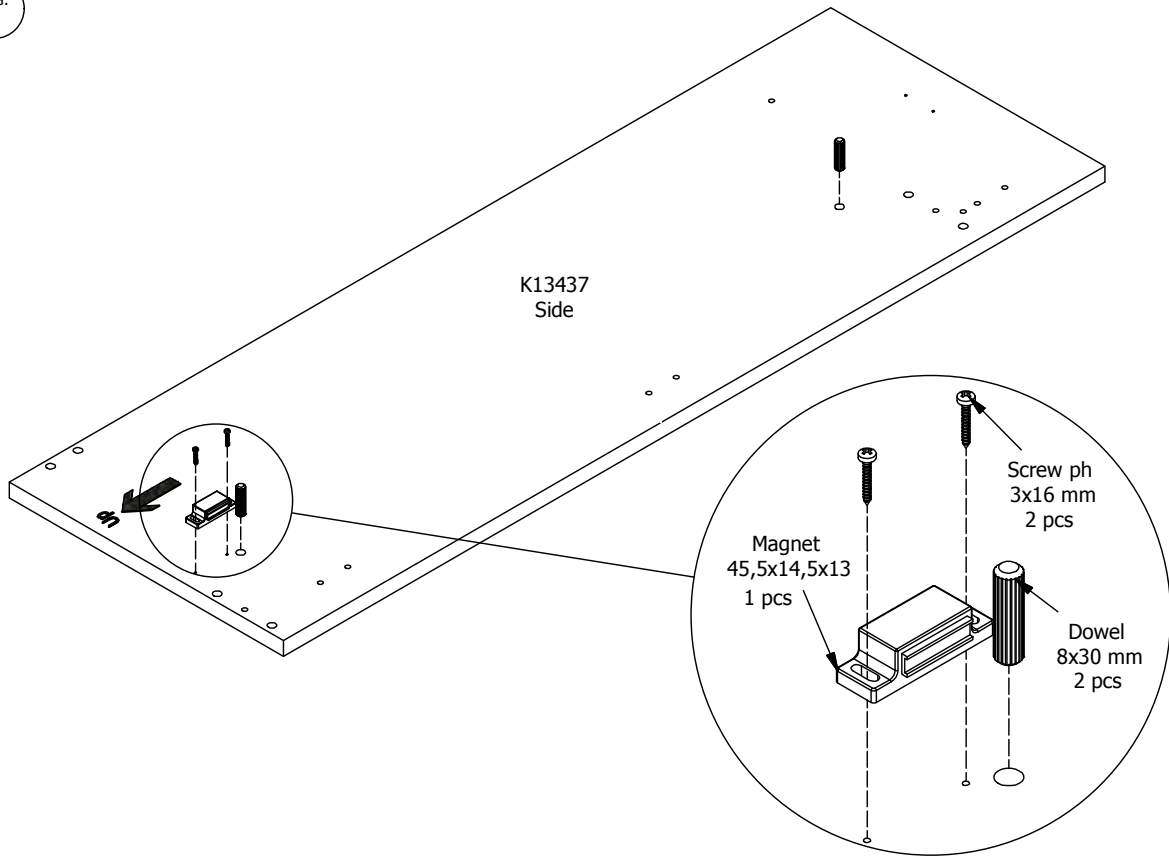
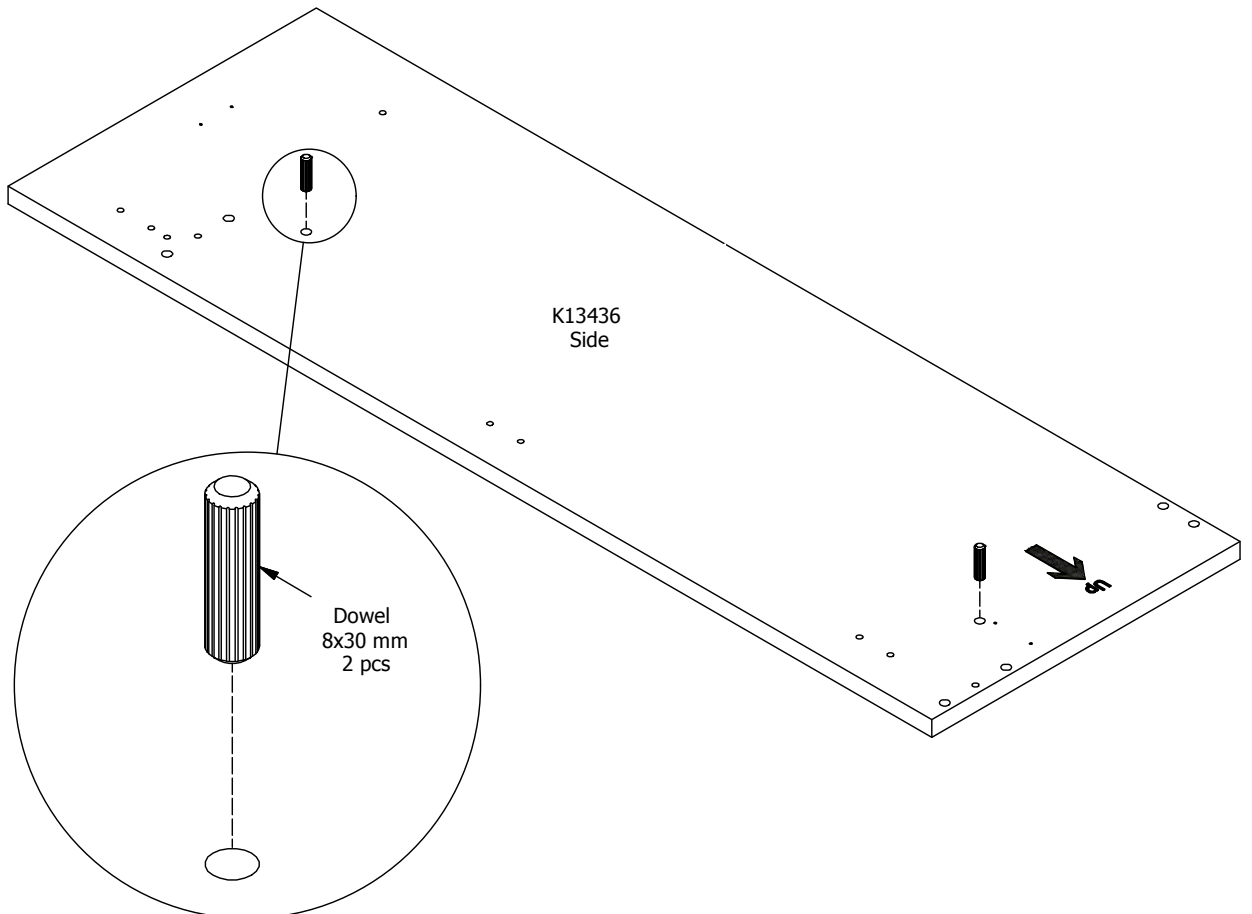

FIG. 6



Method 2 (Siemens)

FIG. 7

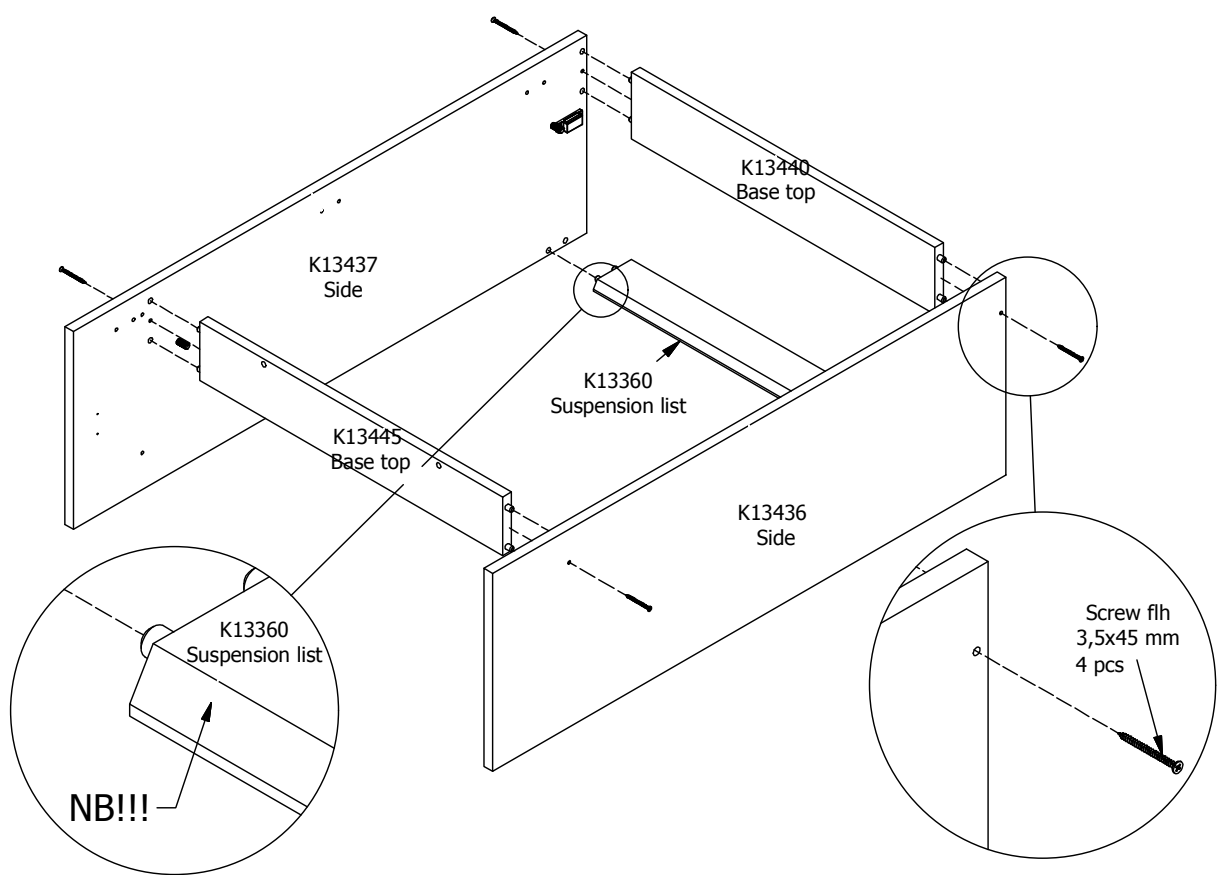

FIG. 8

Method 1 and 2

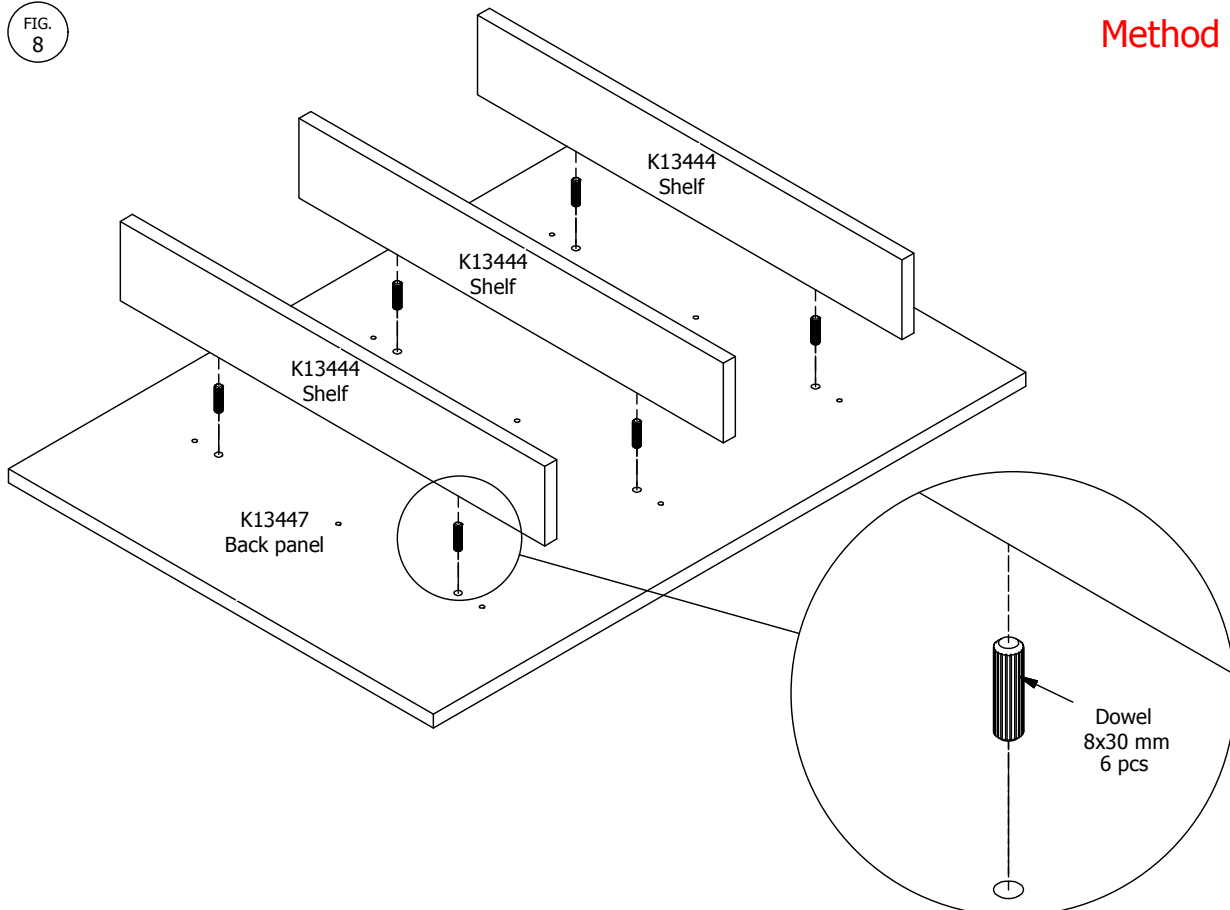

FIG. 9

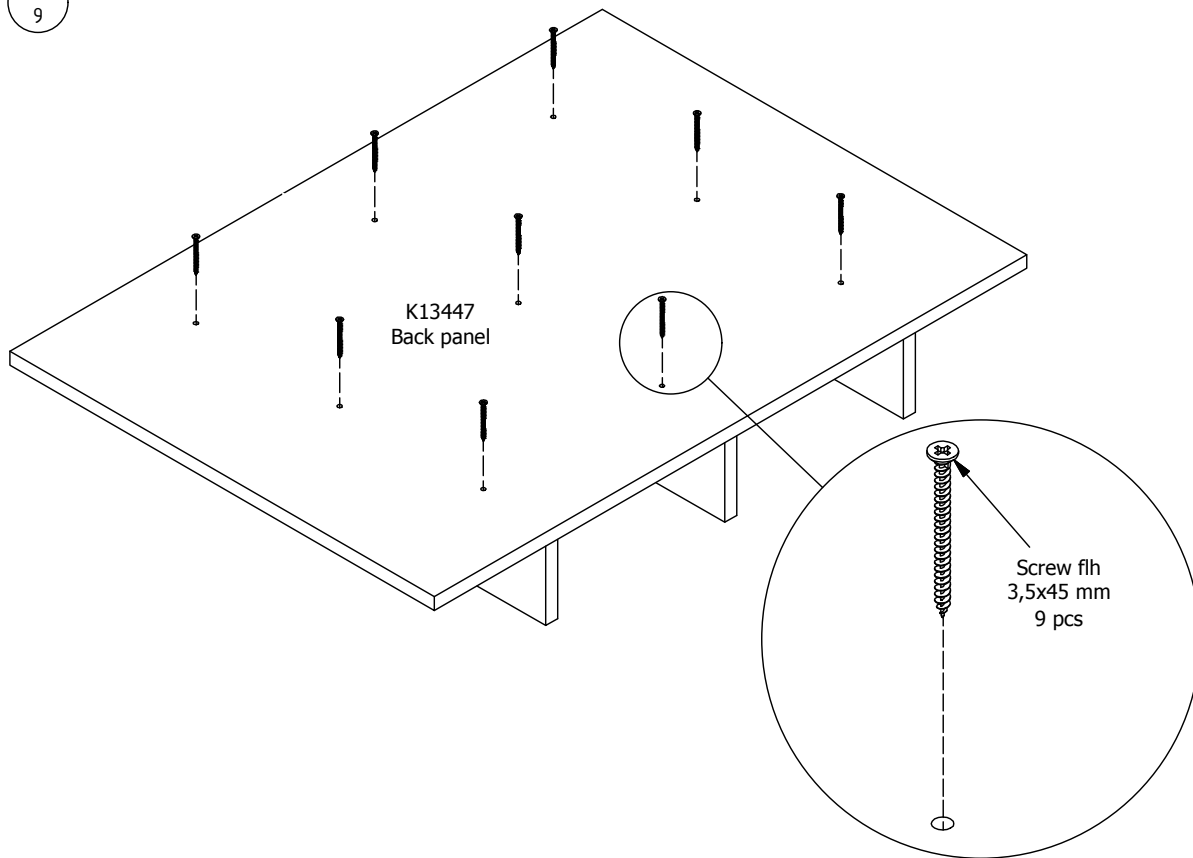

FIG. 10

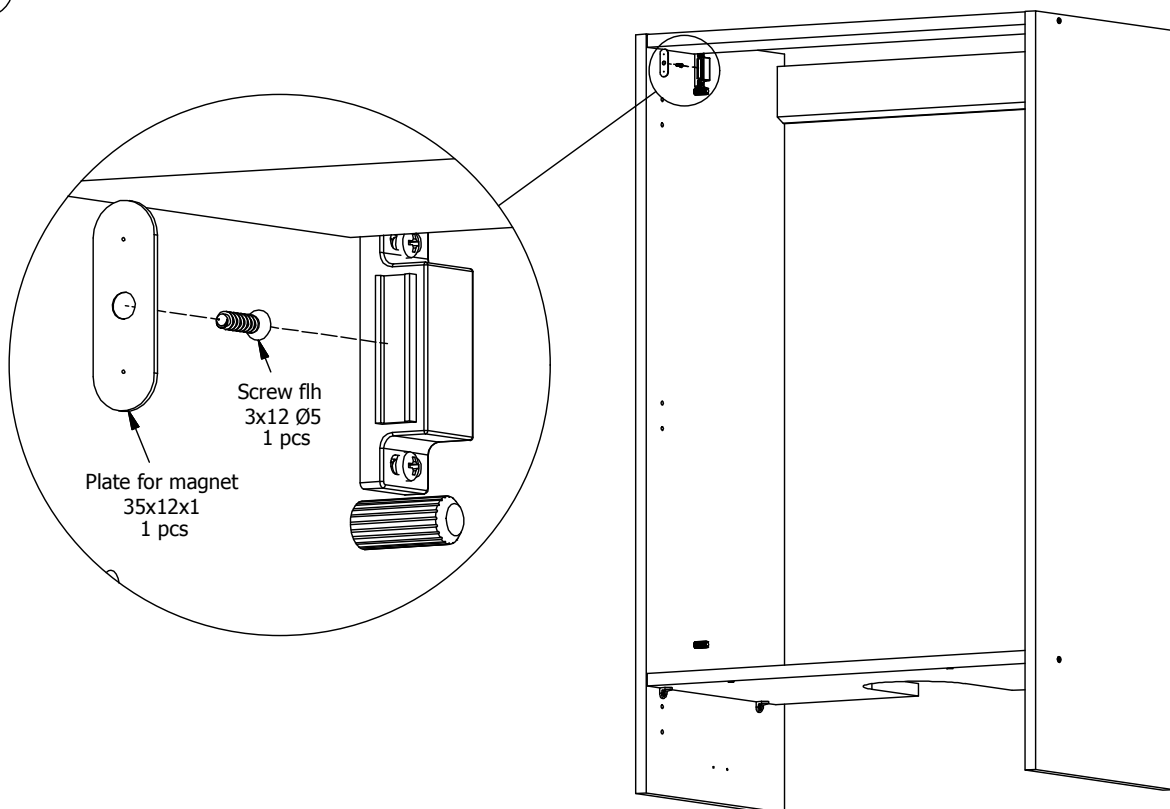
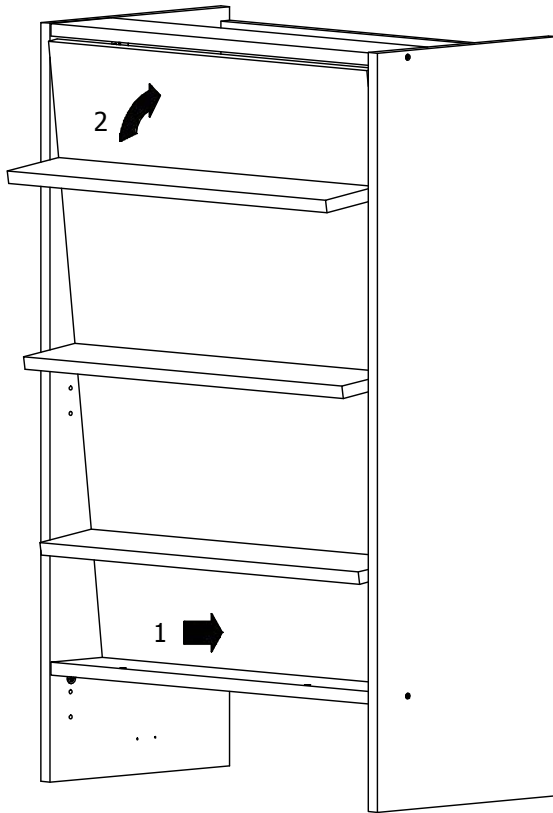

FIG. 11



Push, and the screw will make a mark on the backside, to use to mount the plate for magnet

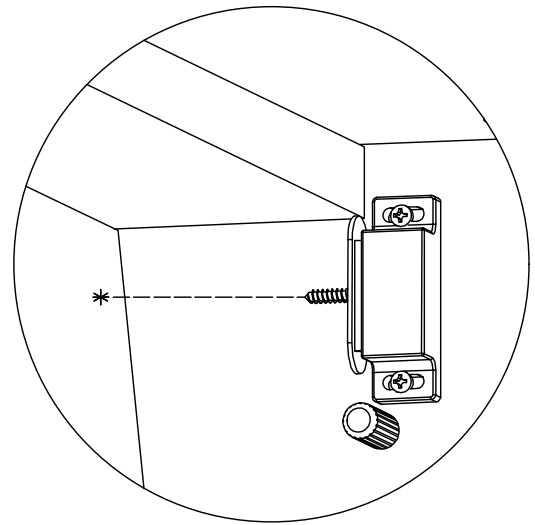
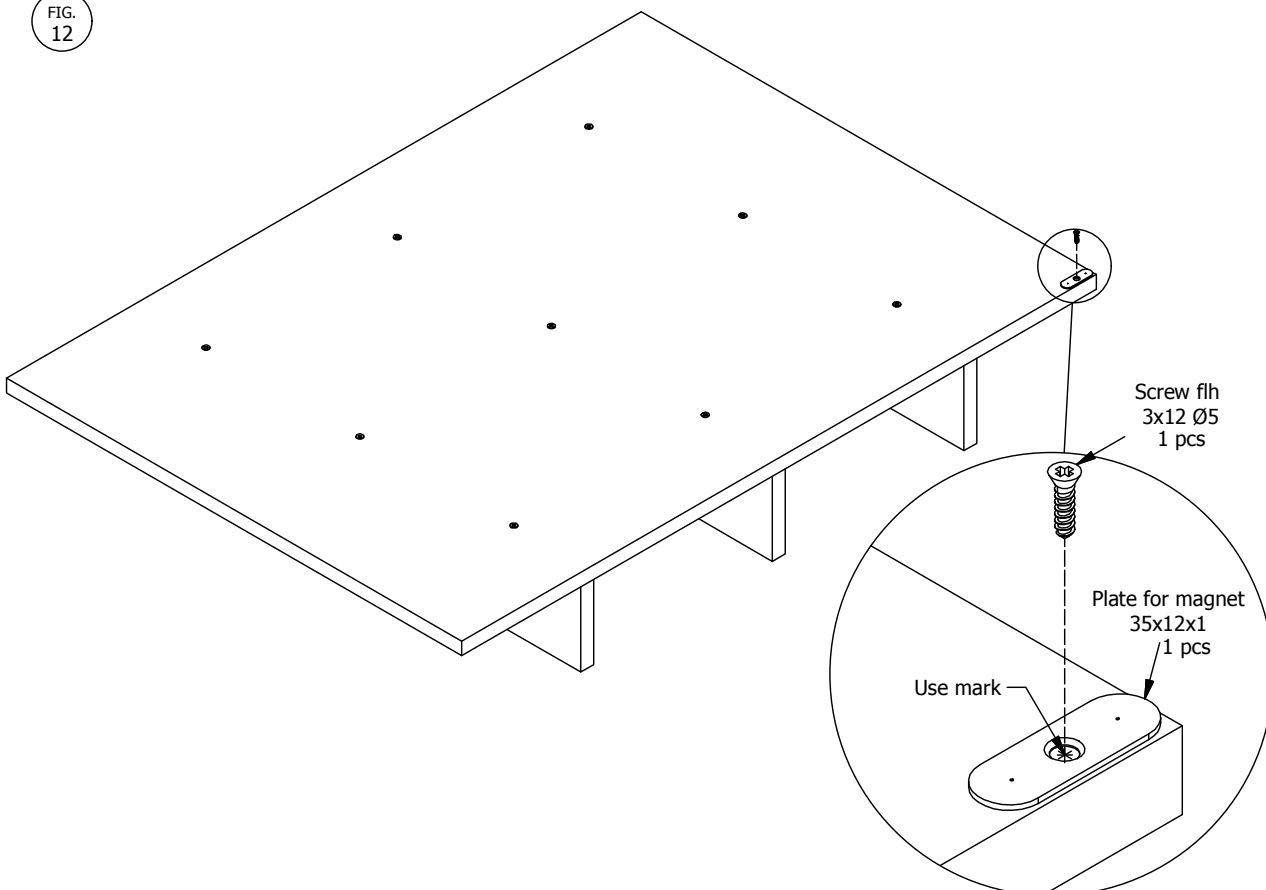

FIG. 12



Screw flh
3x12 Ø5
1 pcs

Plate for magnet
35x12x1
1 pcs

Use mark



FIG. 13

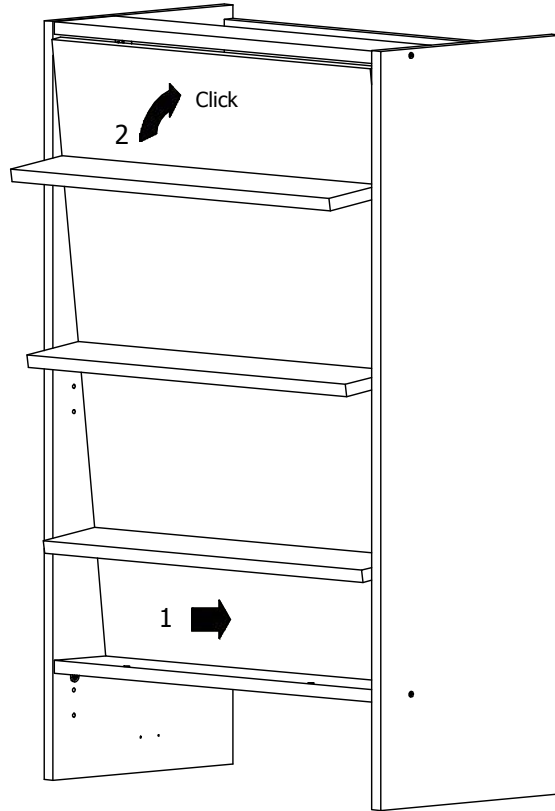

Fig 14

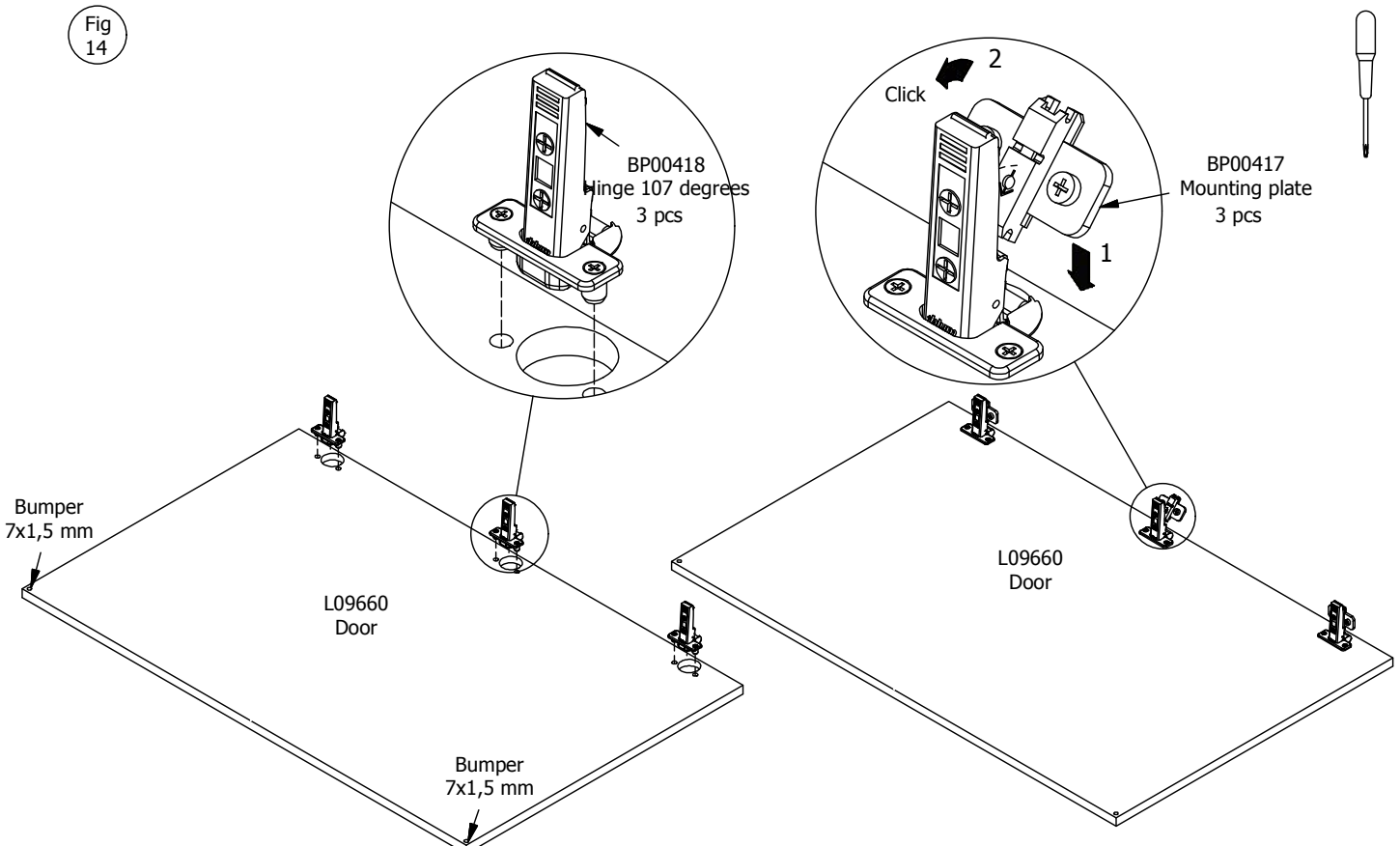

Fig 15

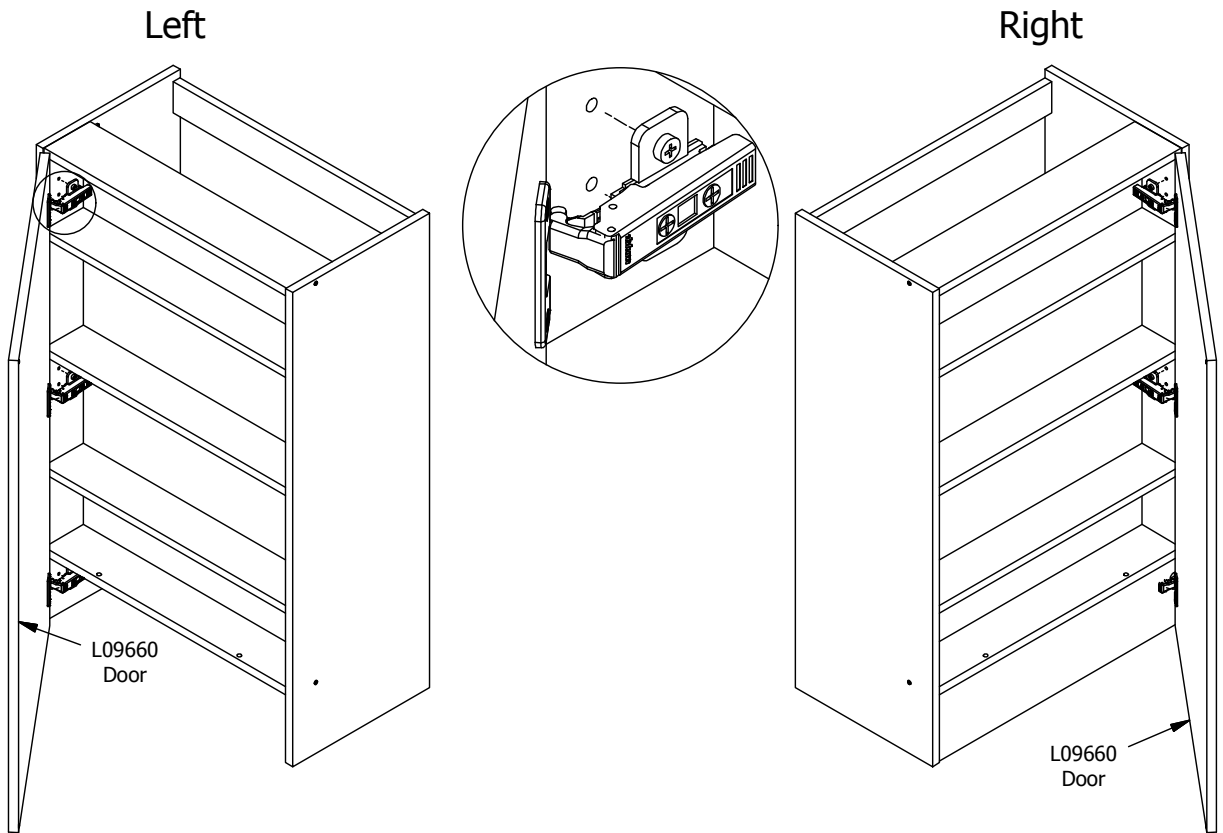

Fig 16

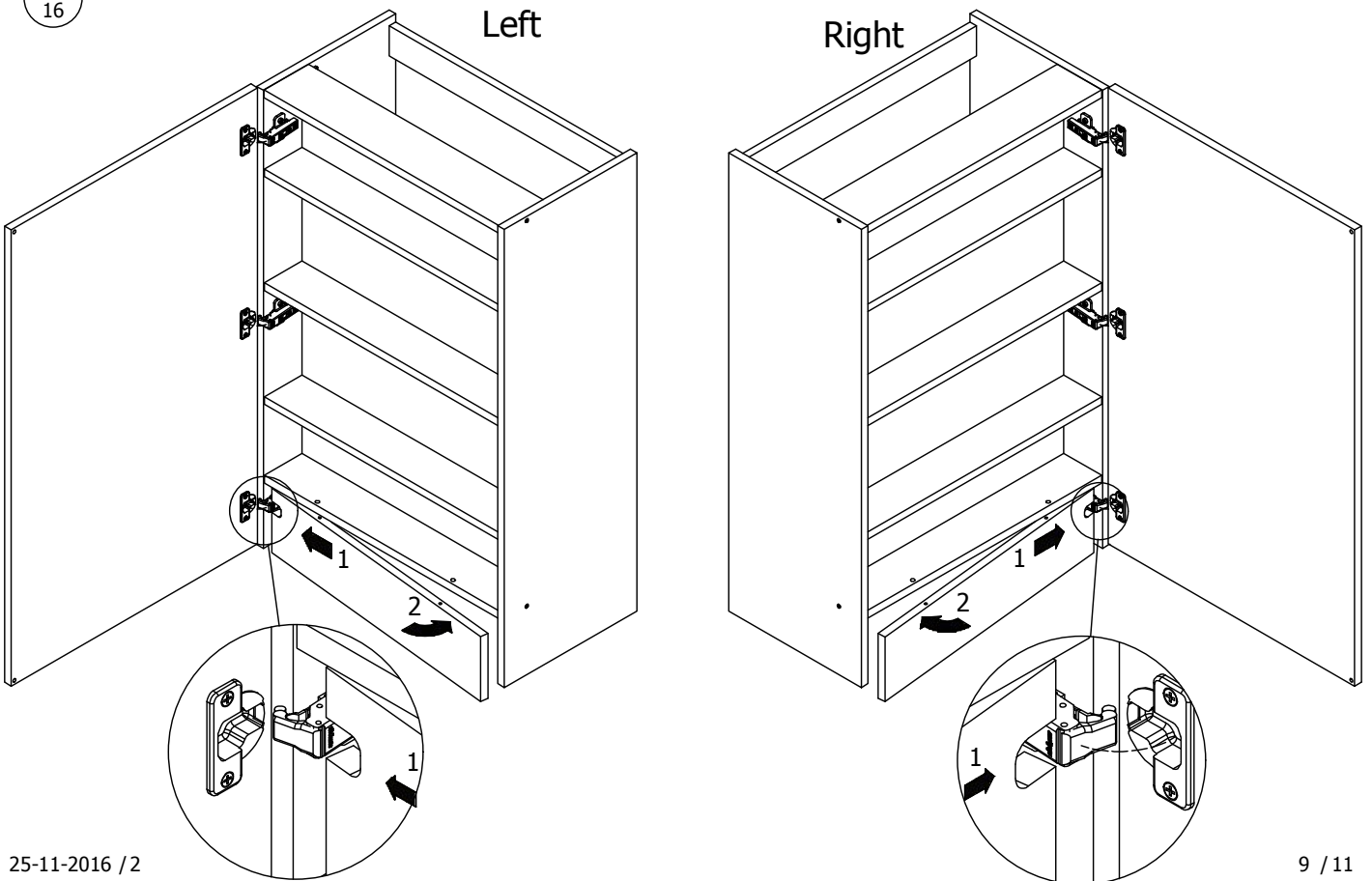
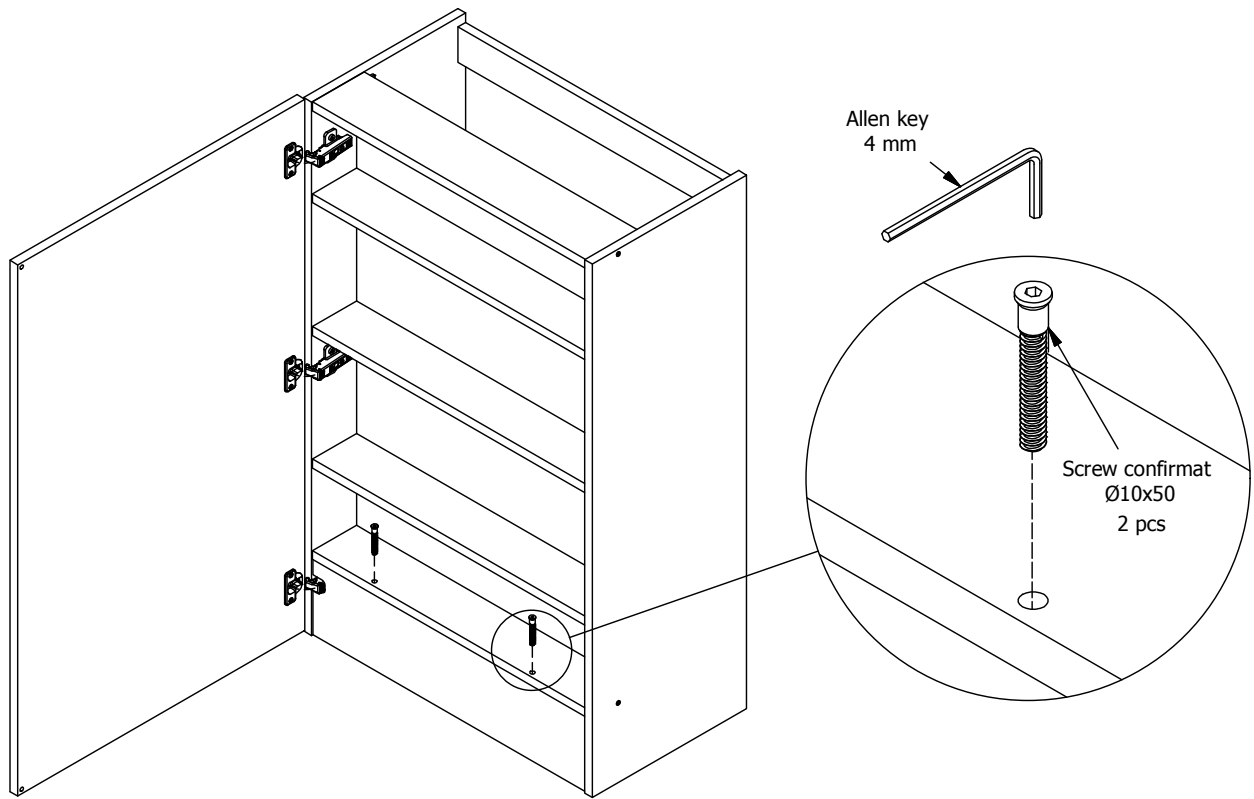

Fig 17



Adjustment

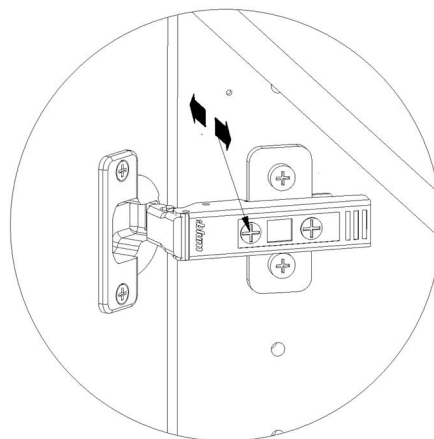
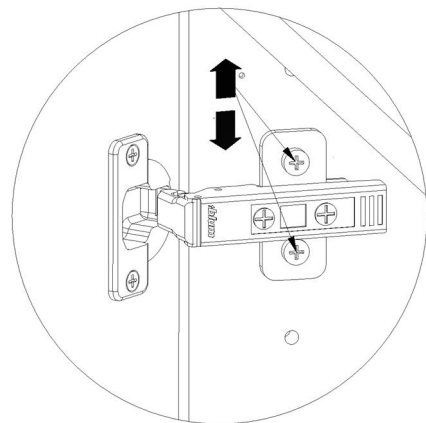
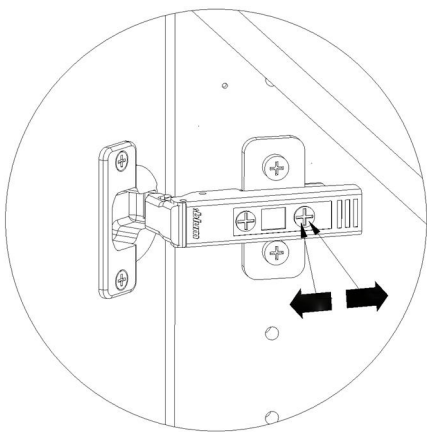

Fig 18

