

**kvik**

**MC648**

**Method 1 (Thermex)**

**Method 2 (Siemens/Bosch)**

DC48,\*\*\*,\*\*\*

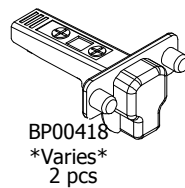
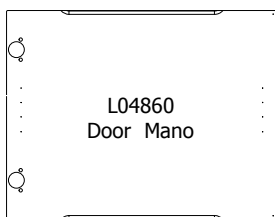
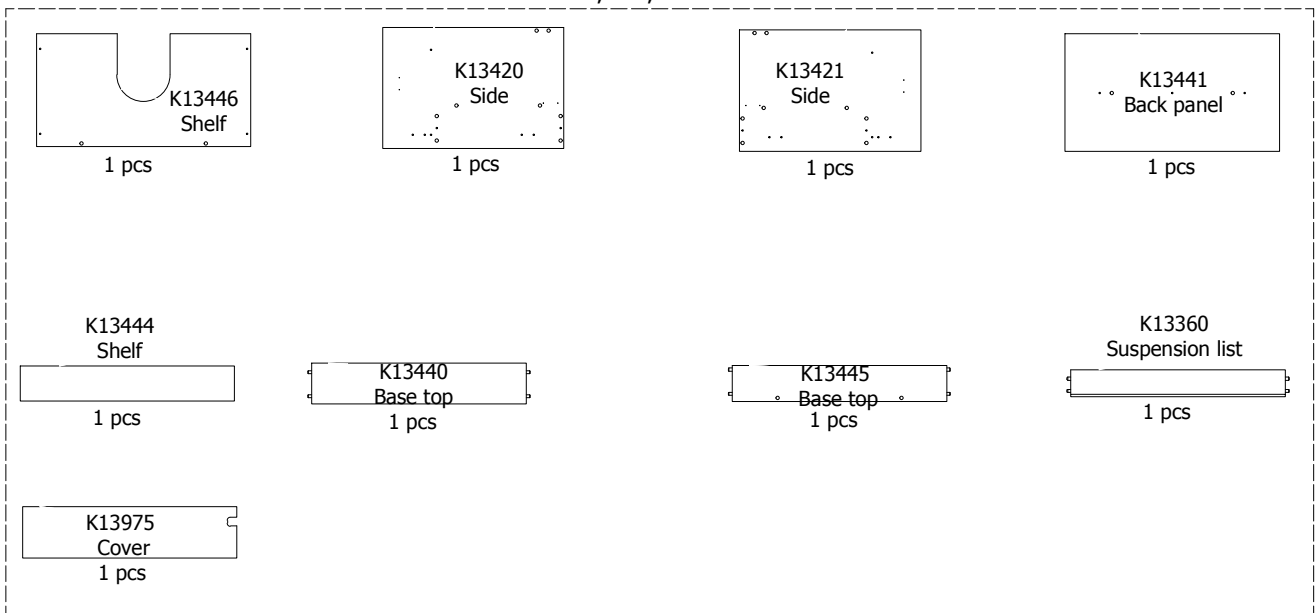

BP00029

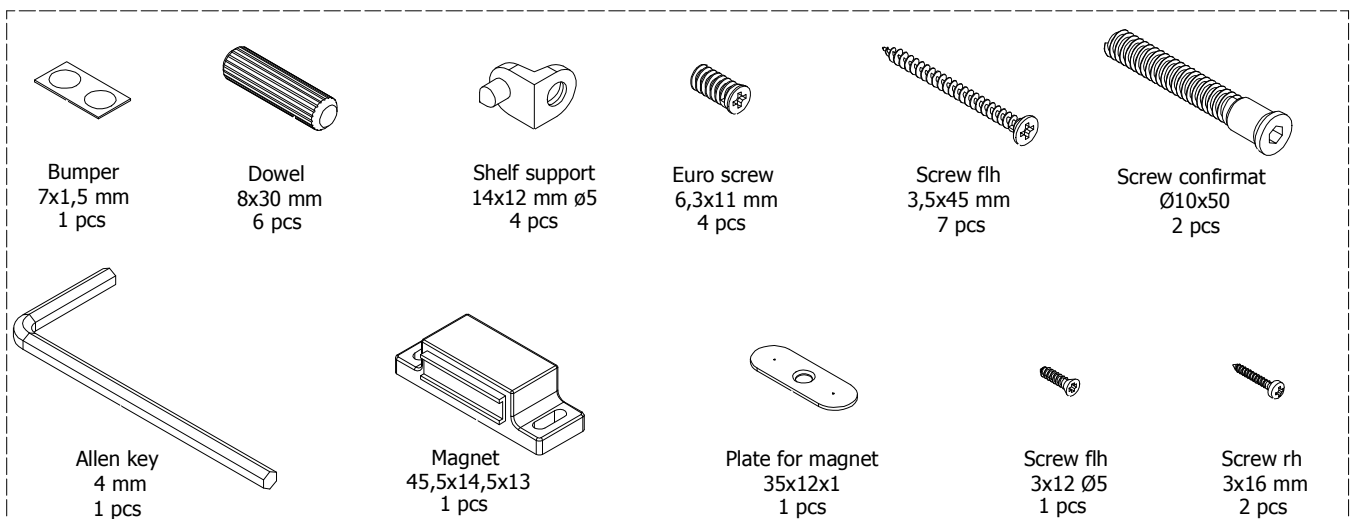

**Method 1 (Thermex)**

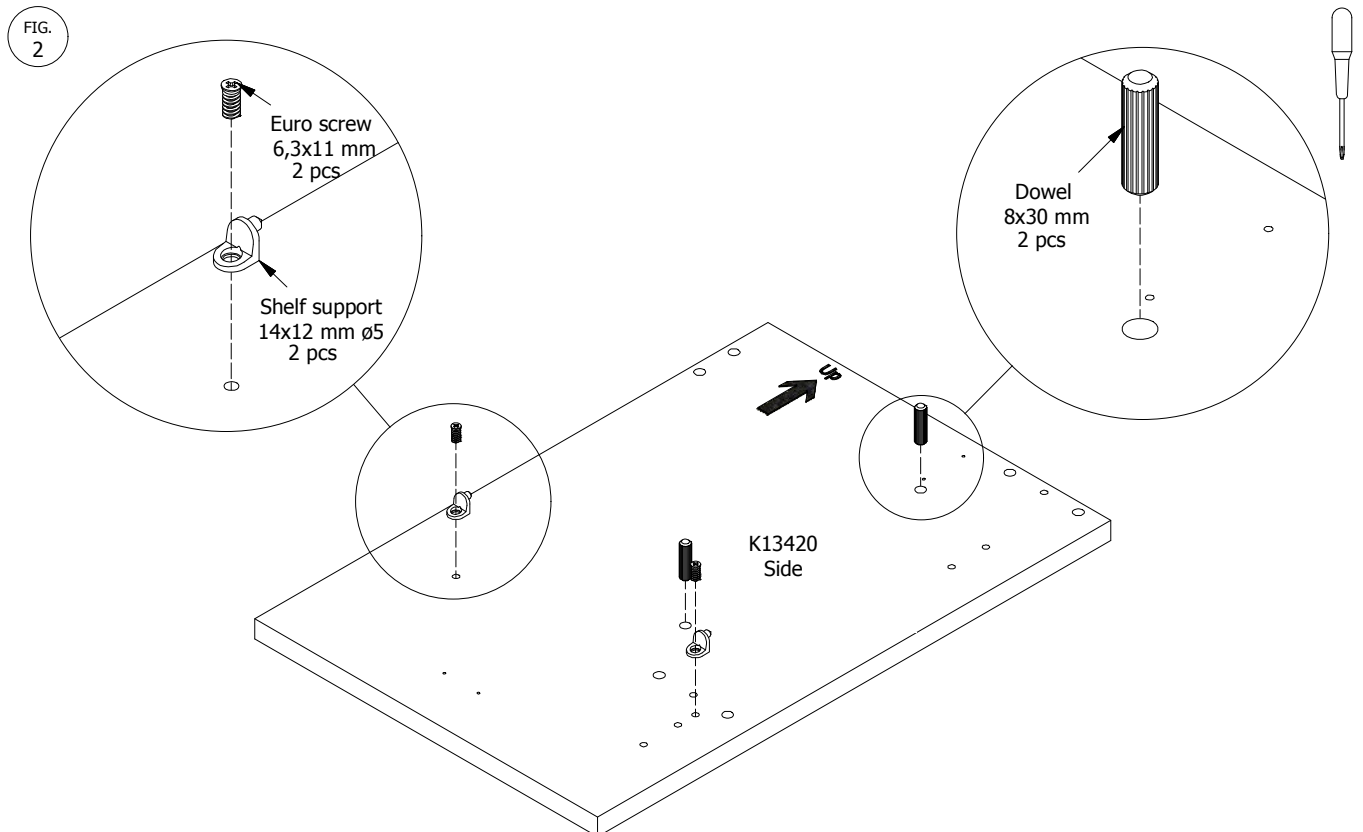
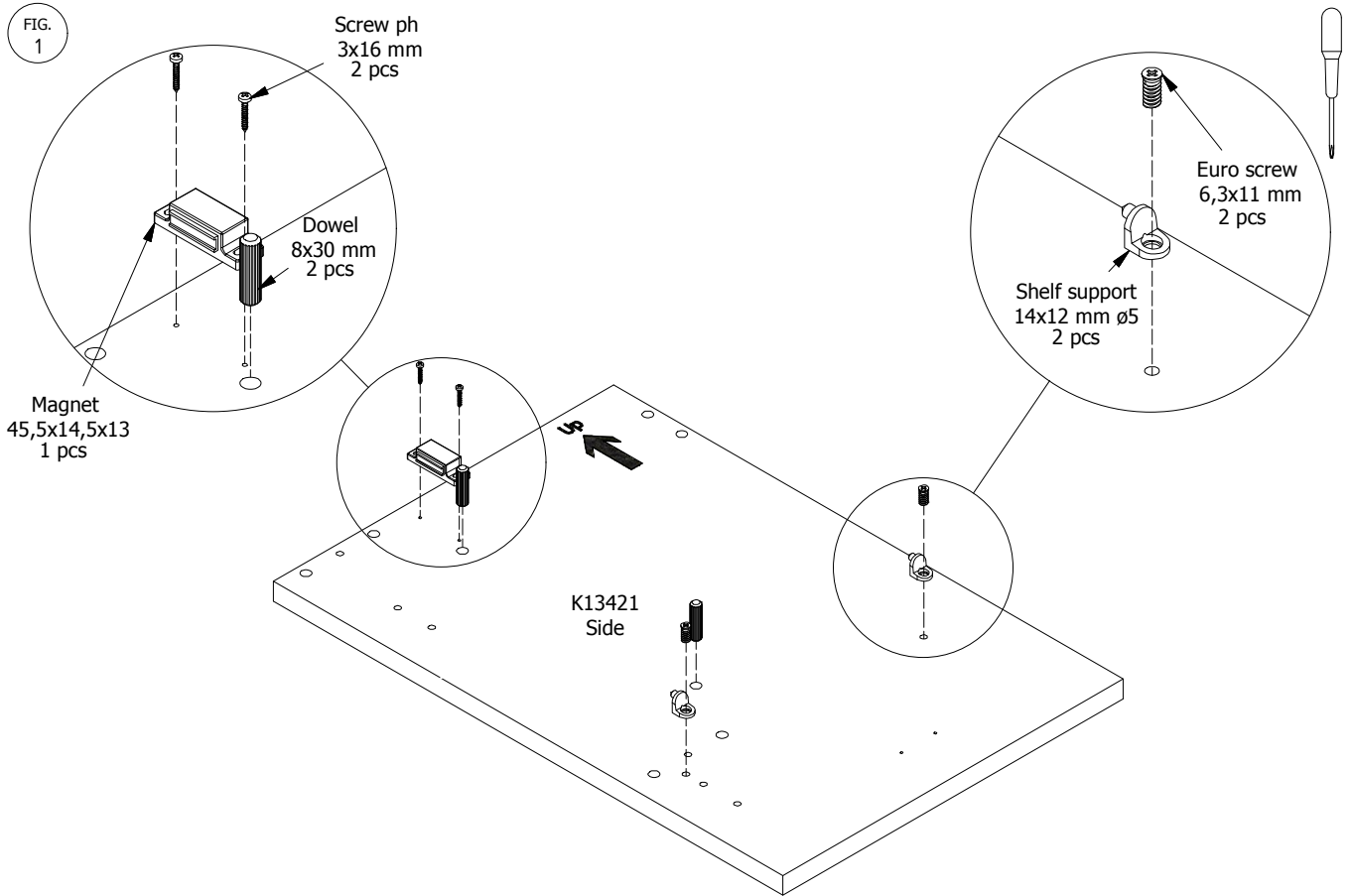

FIG. 3

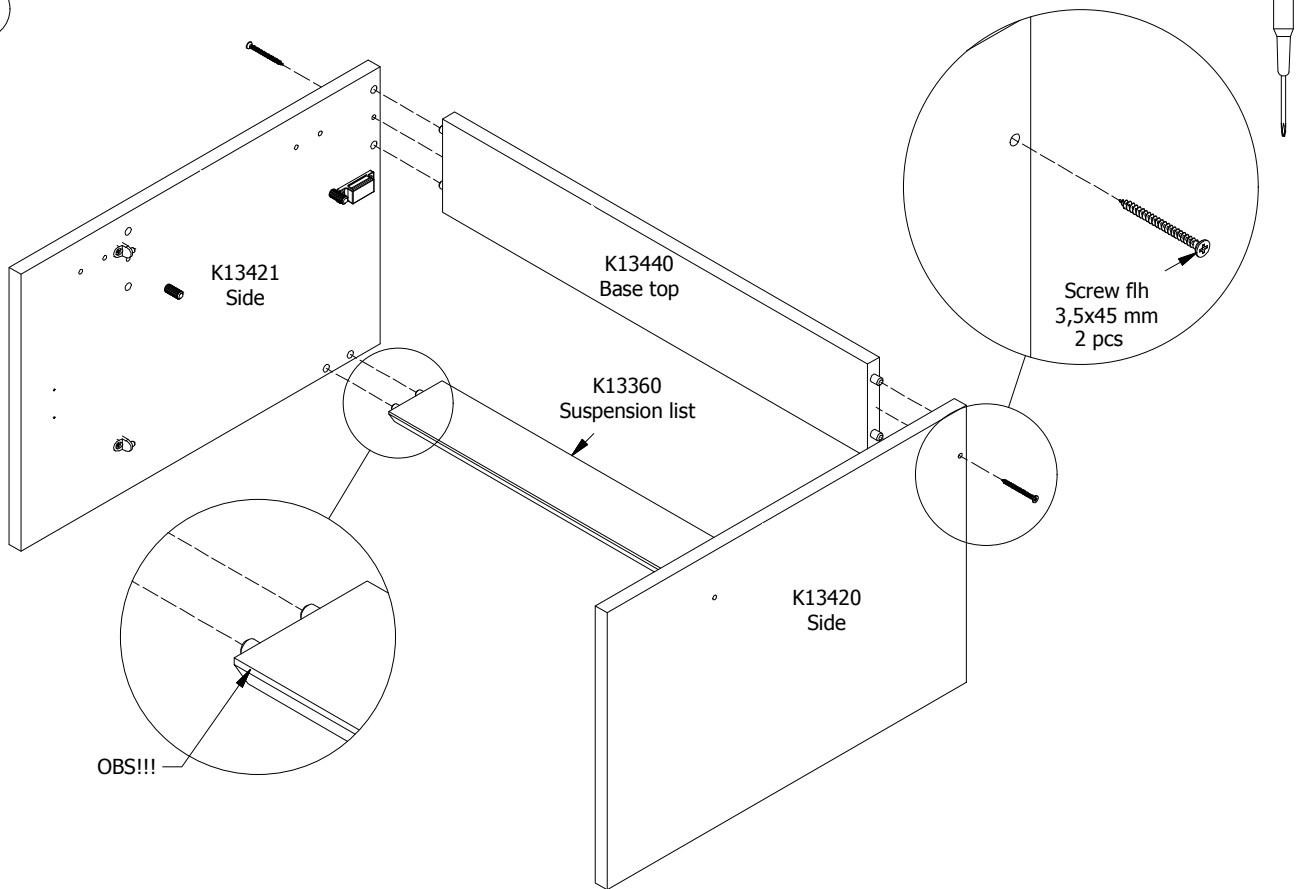
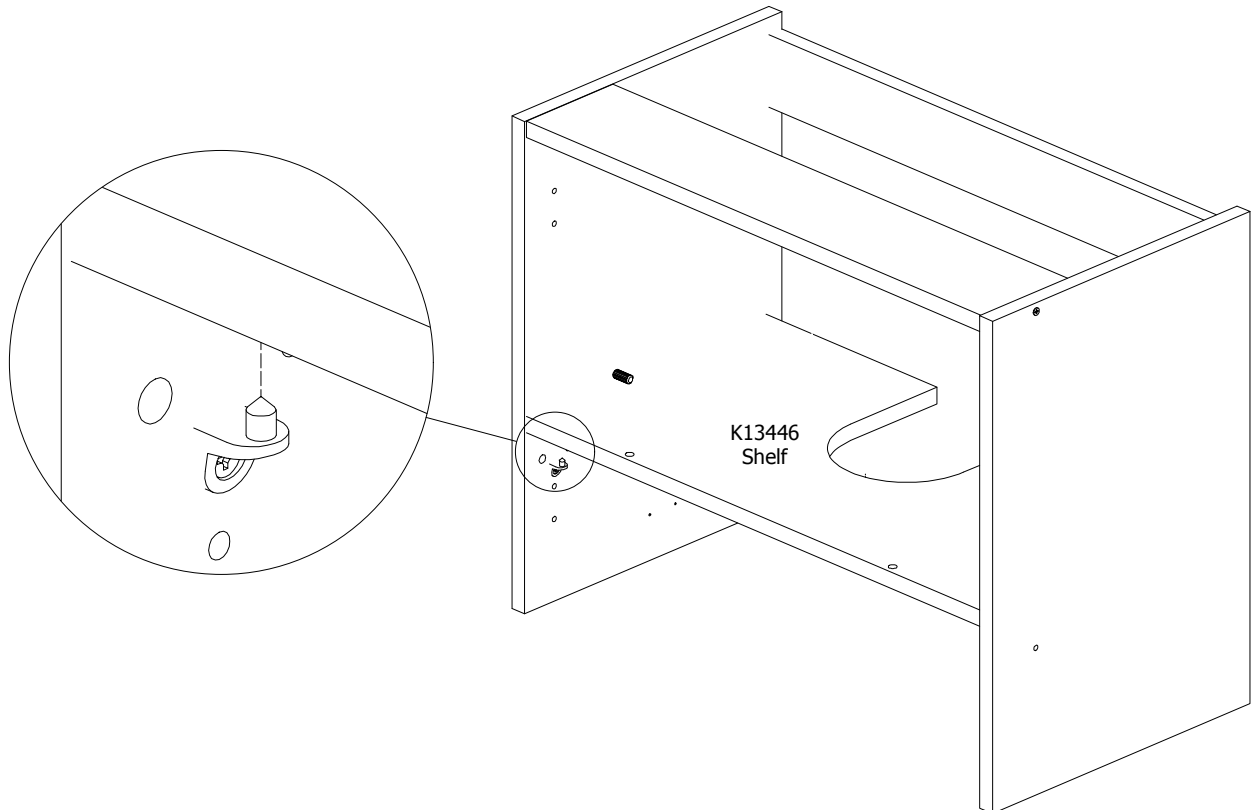

FIG. 4



Method 2 (Siemens/Bosch)

FIG. 5

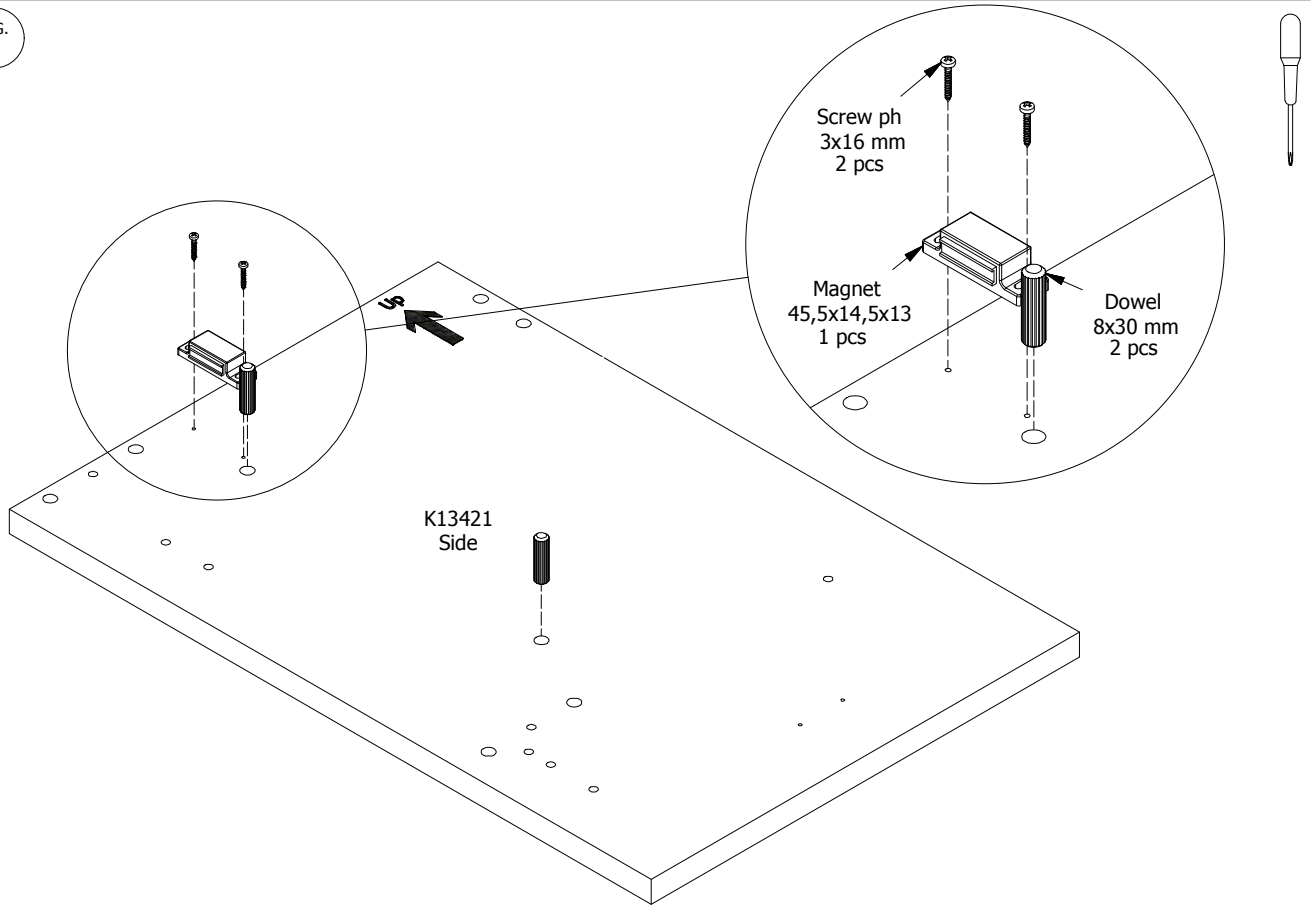

FIG. 6

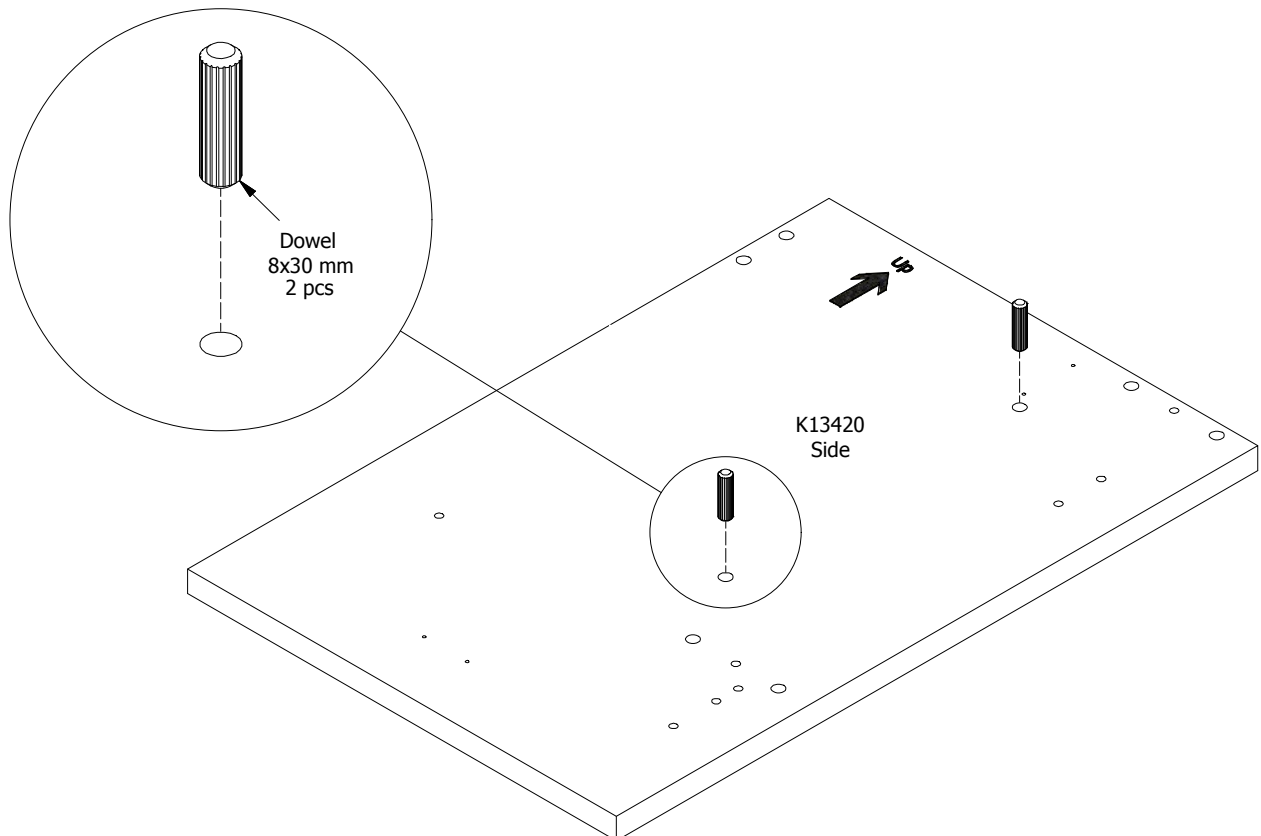

FIG. 7

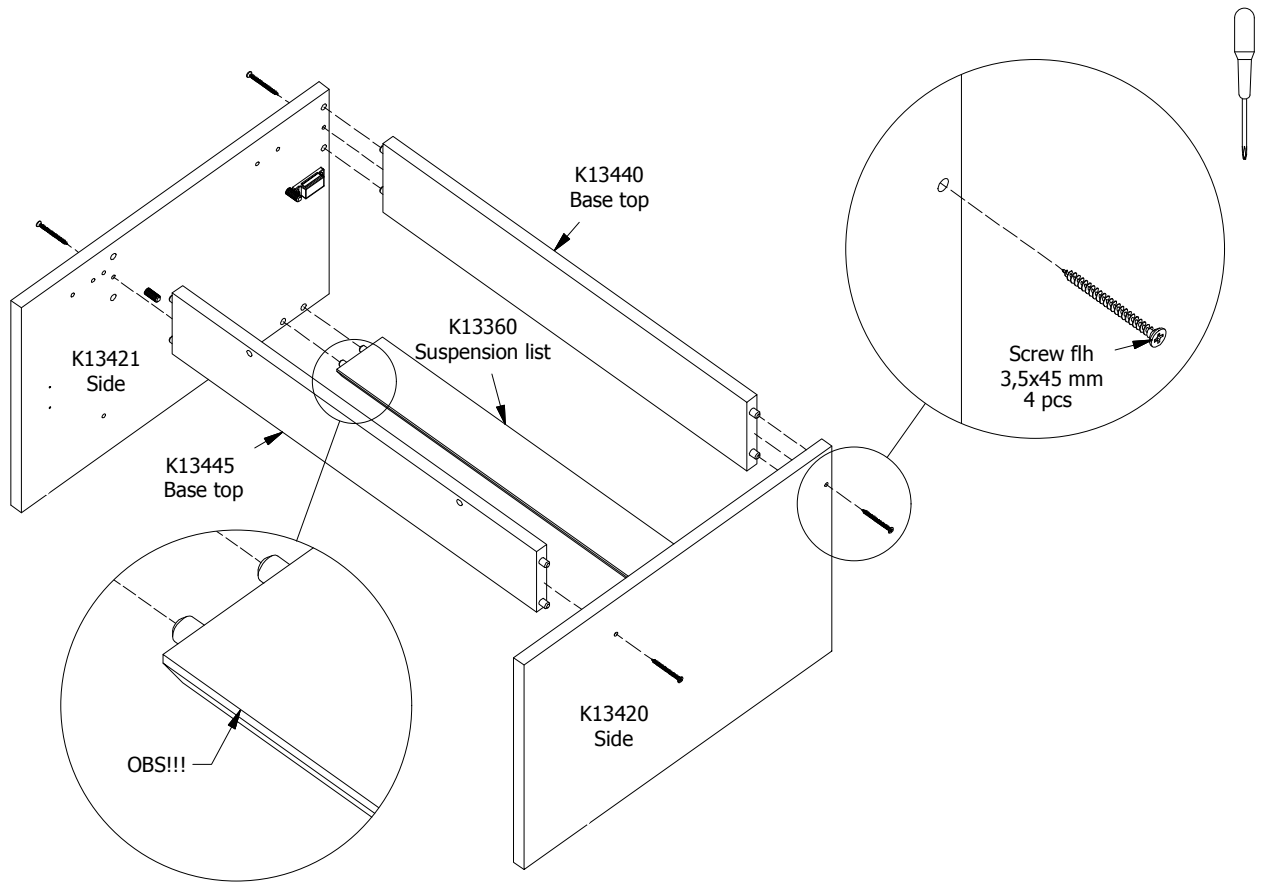

FIG. 8

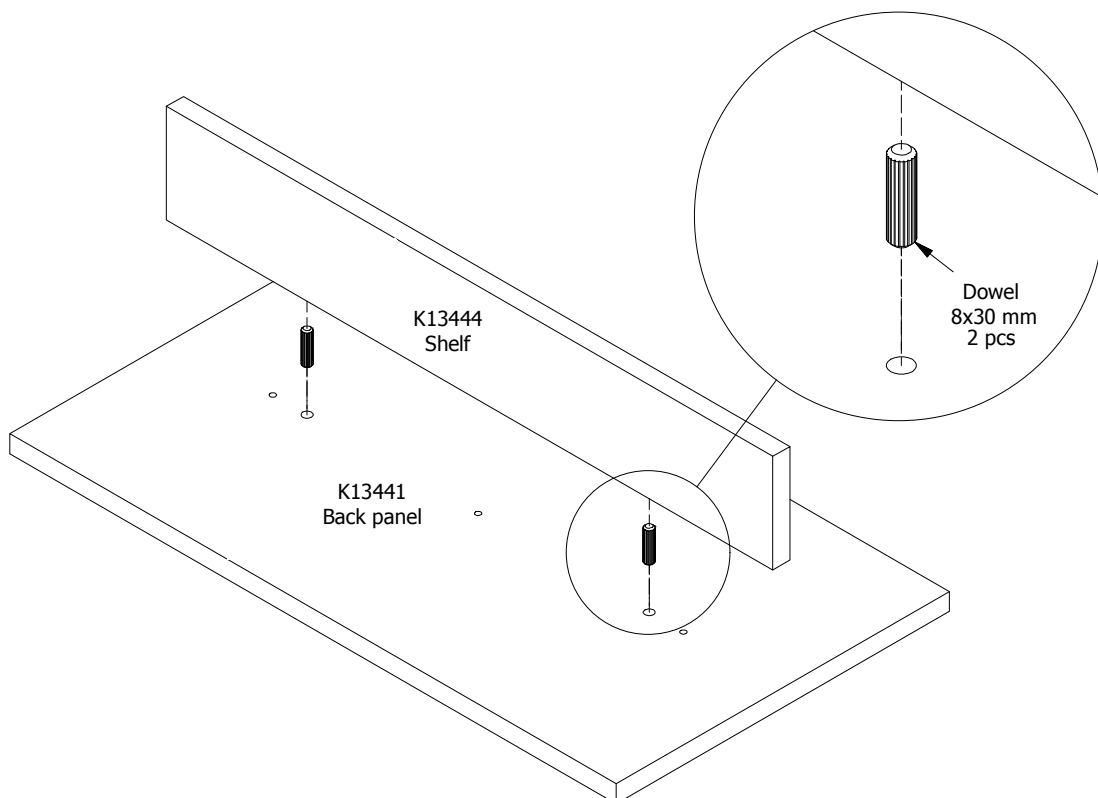

FIG. 9

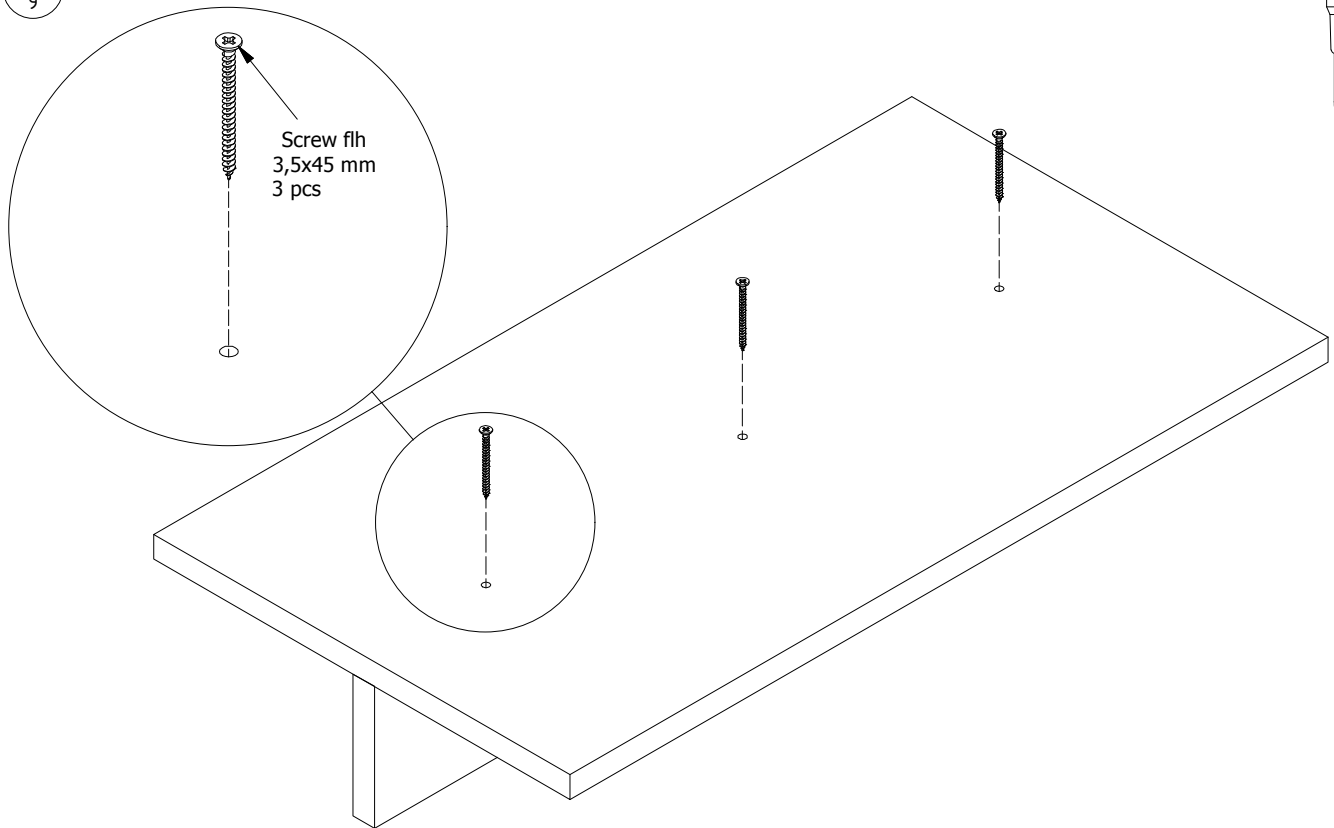

FIG. 10

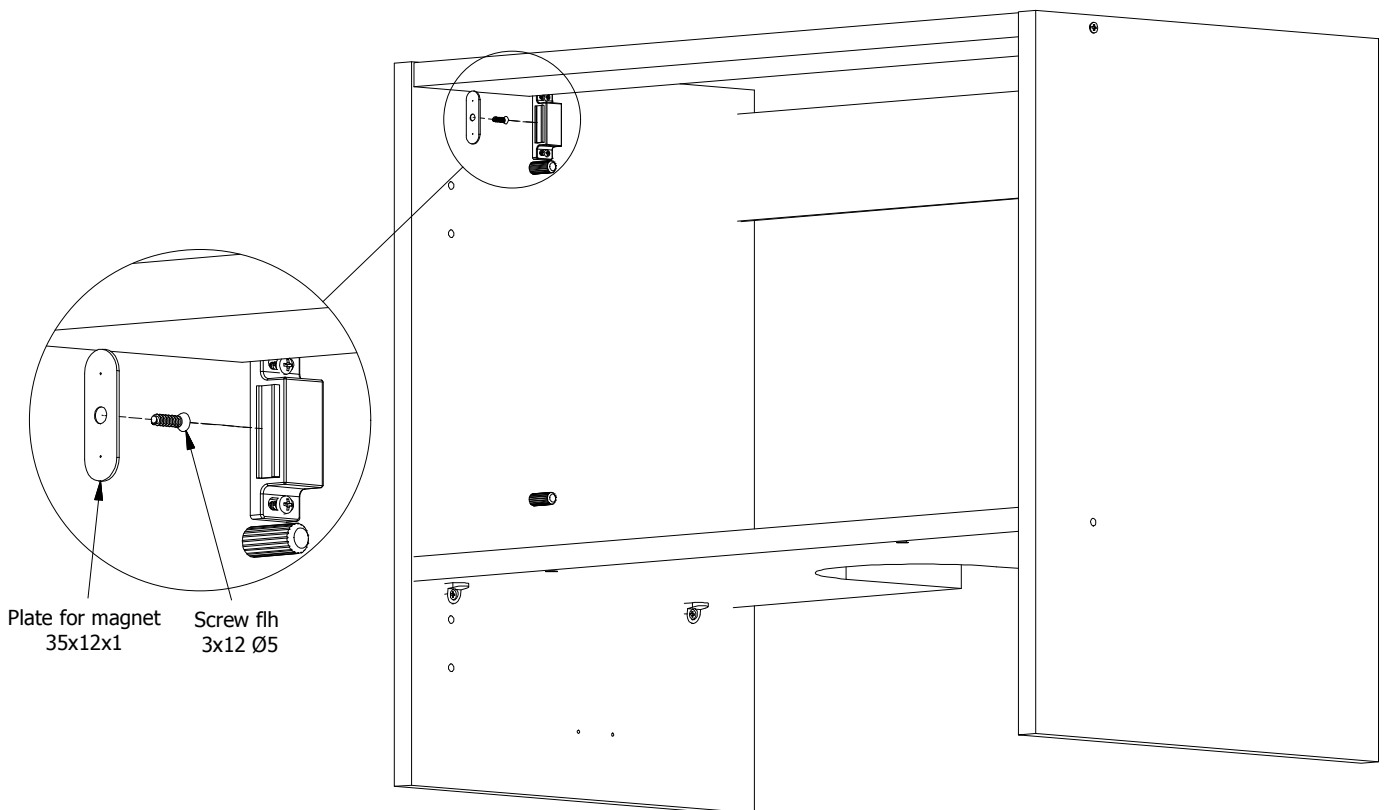

FIG. 11

Push, and the screw will make a mark on the backside, to use to mount the plate for magnet

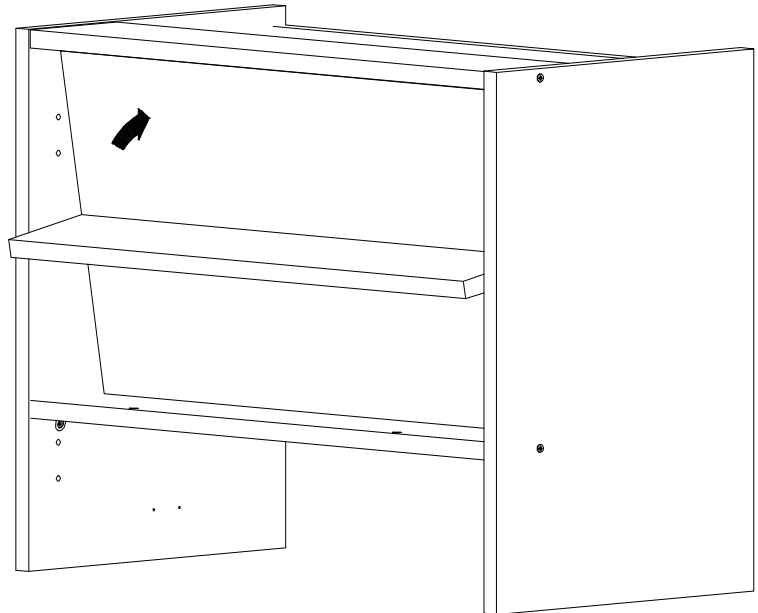

FIG. 12

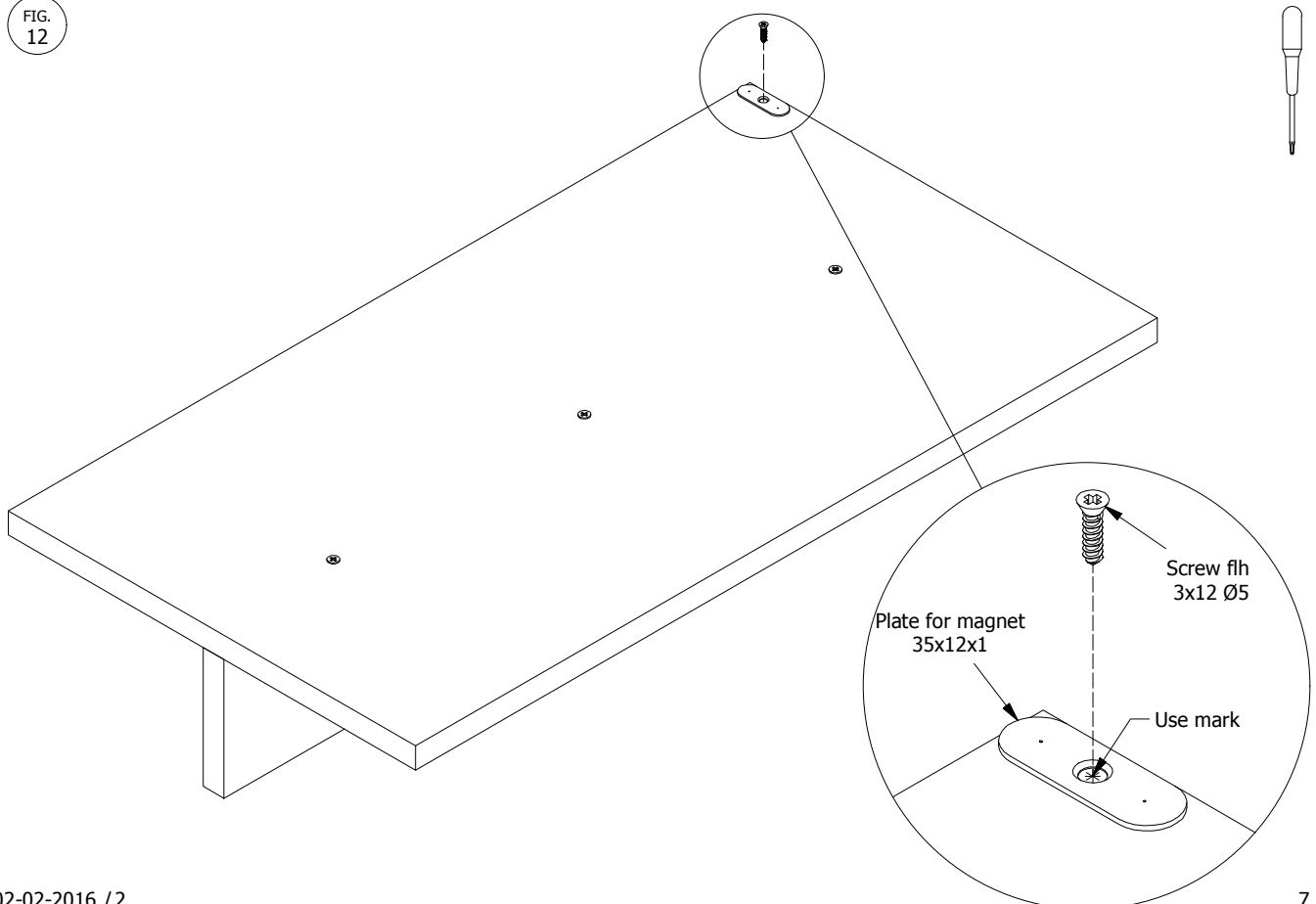

FIG. 13

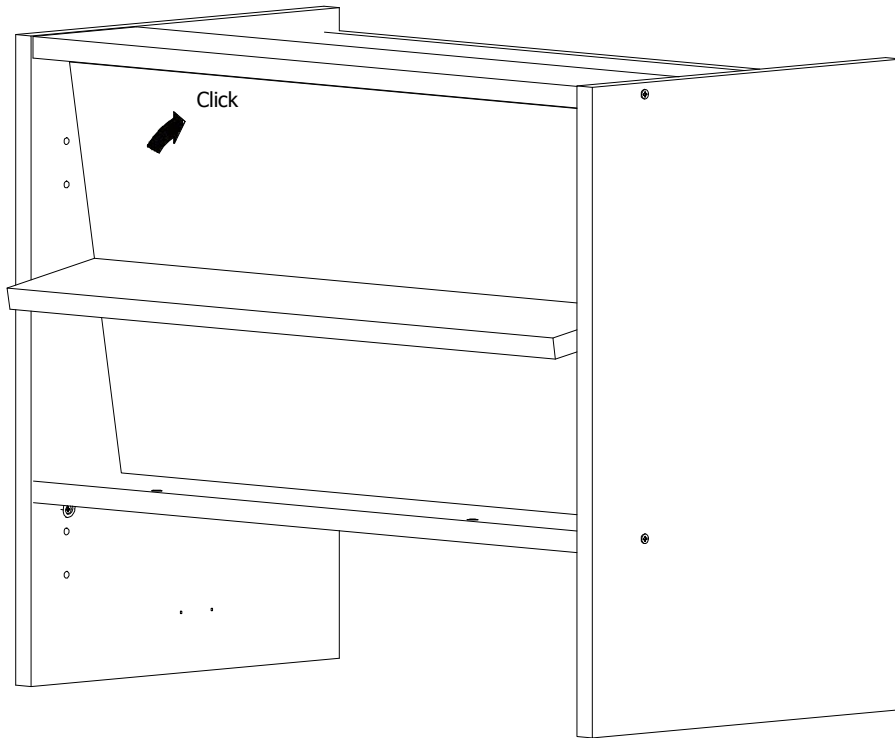

Fig 14

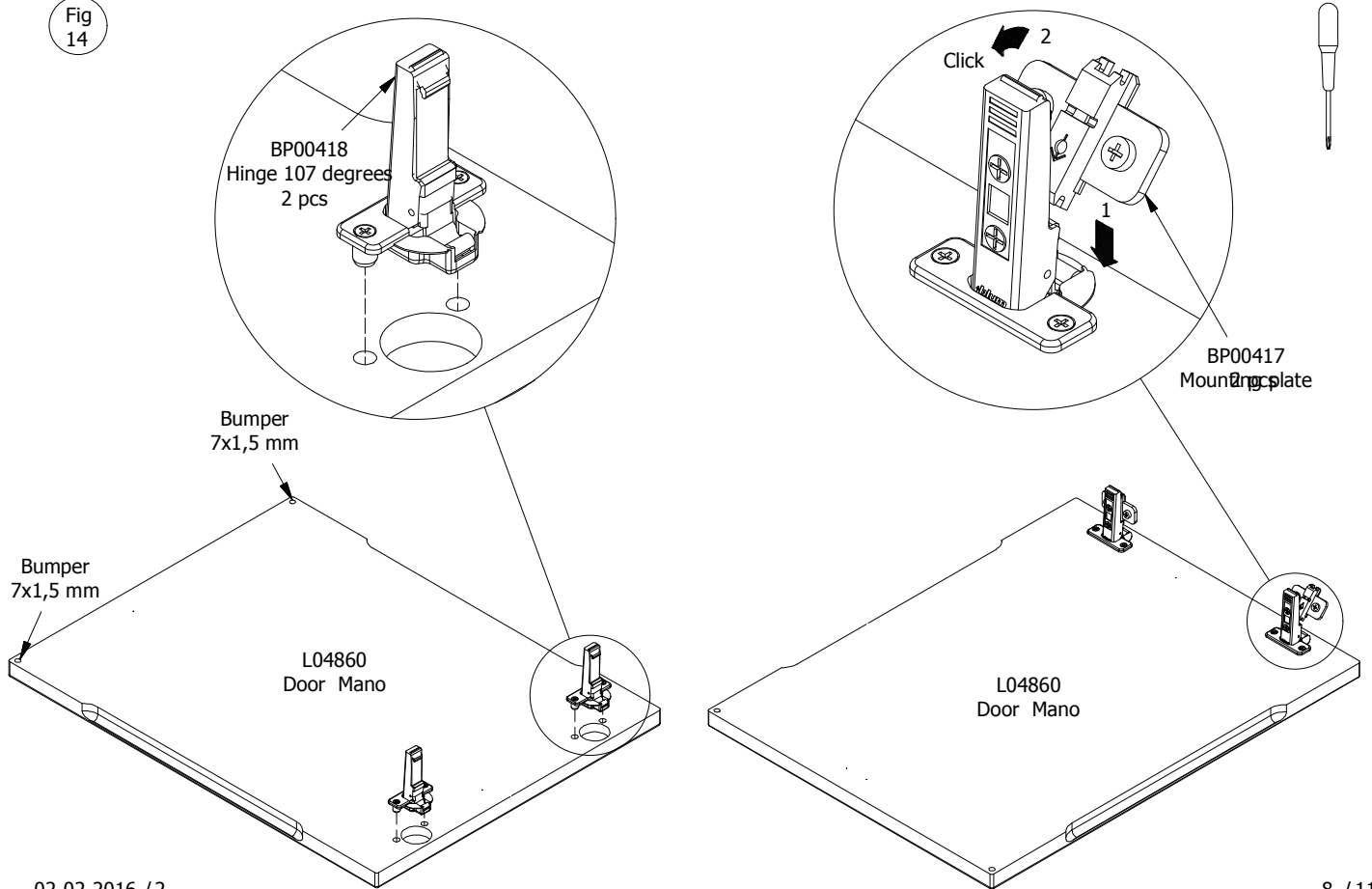



Fig 15

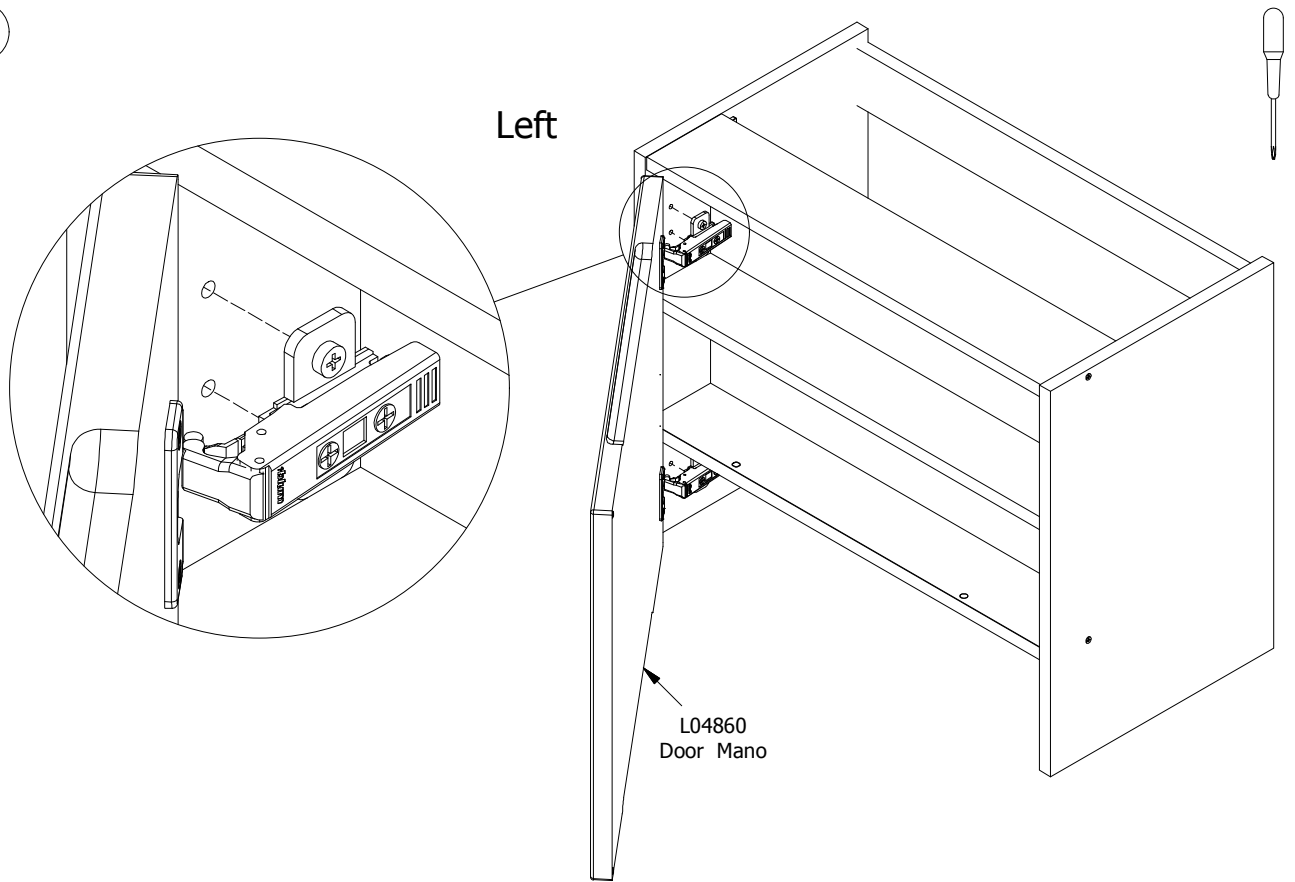

Fig 16

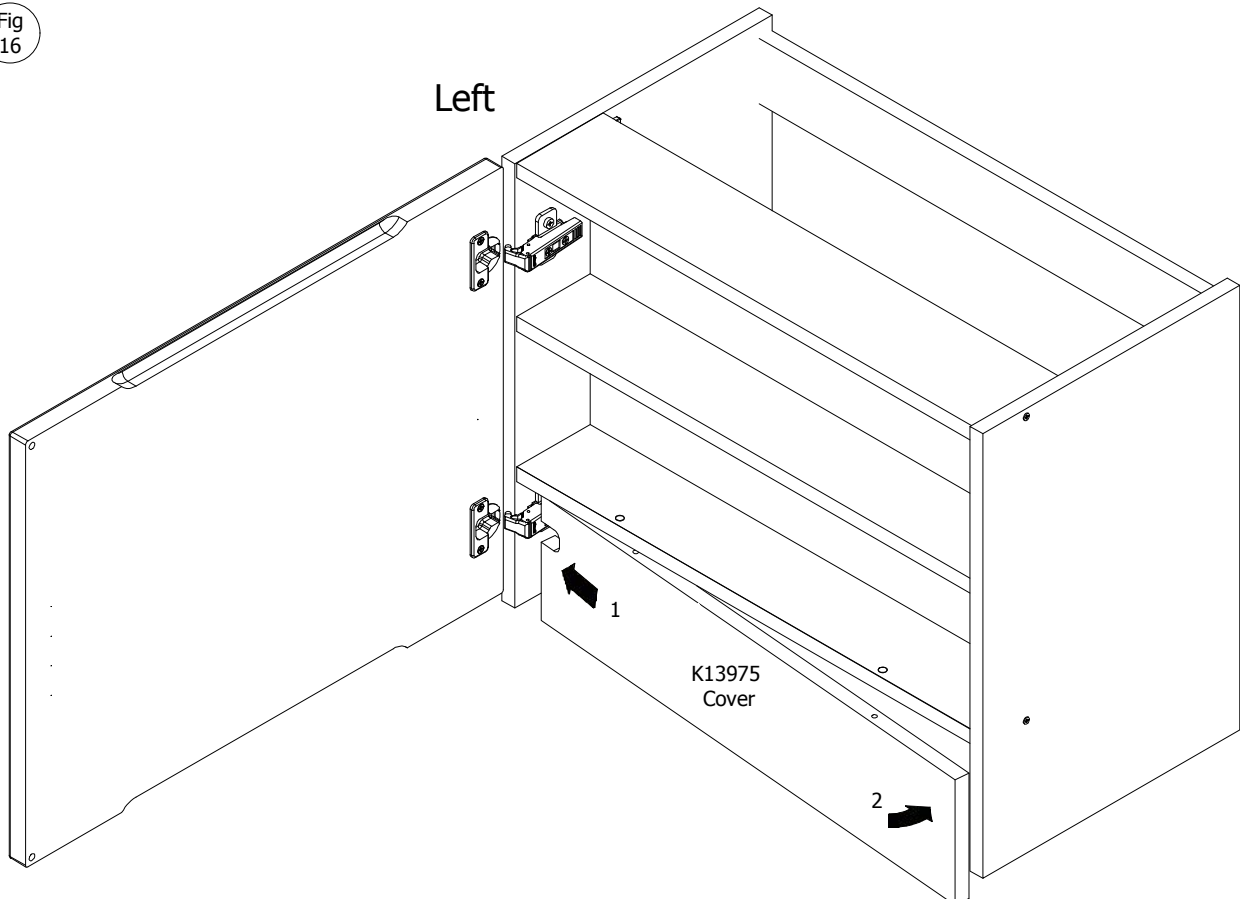

Fig 17

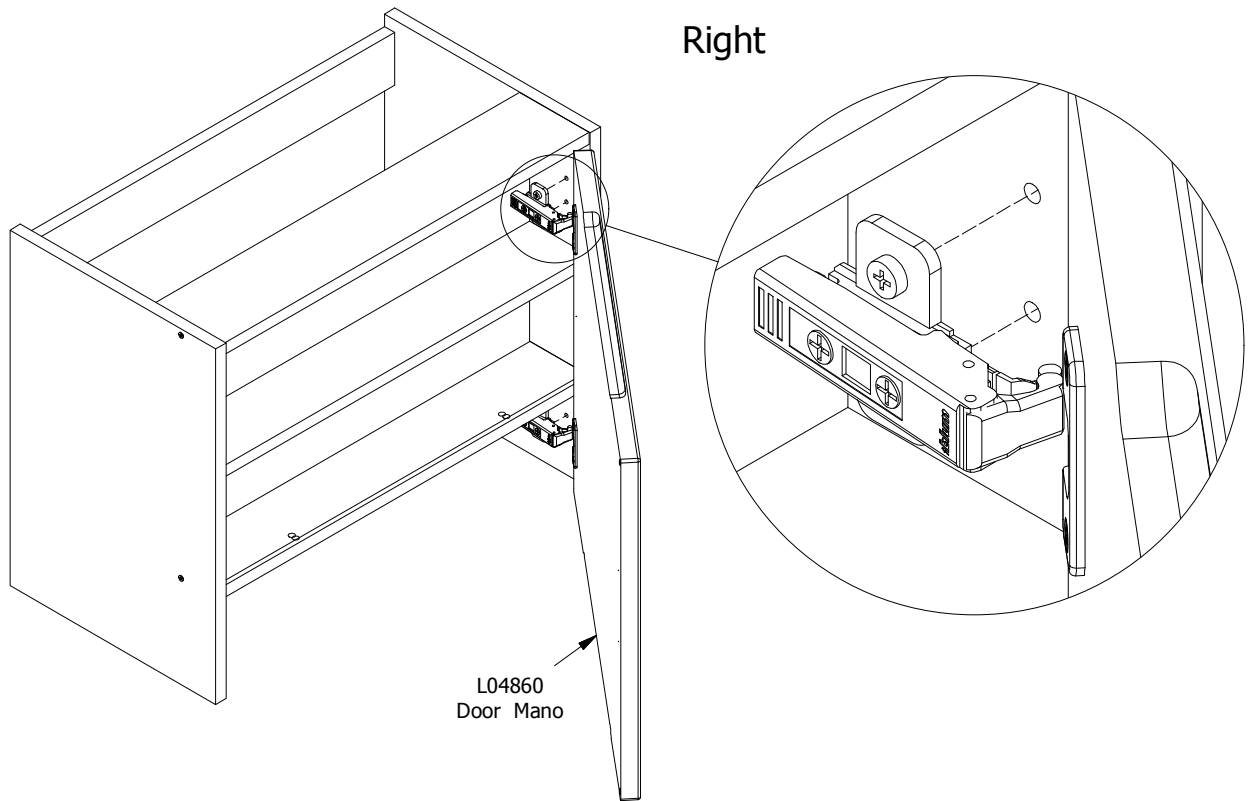
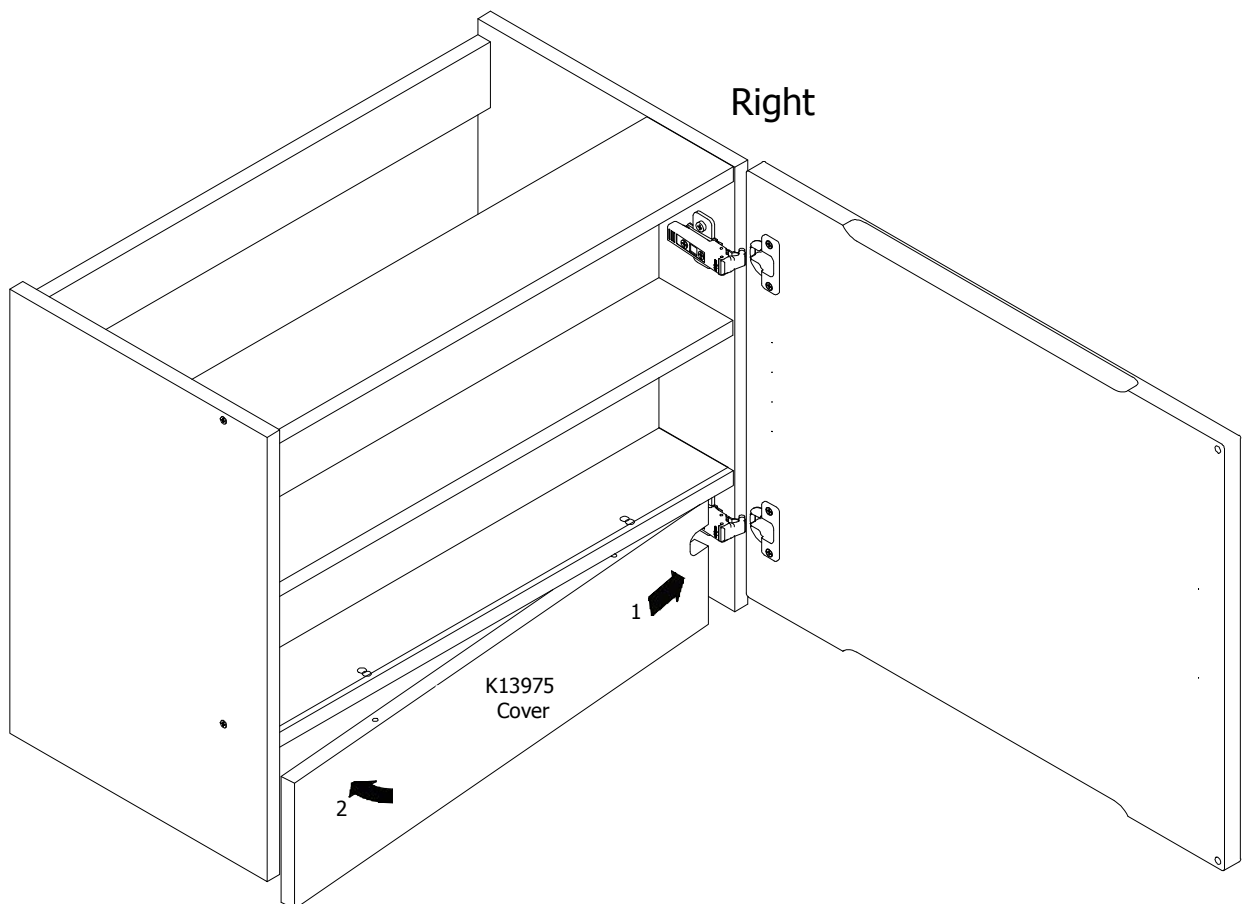
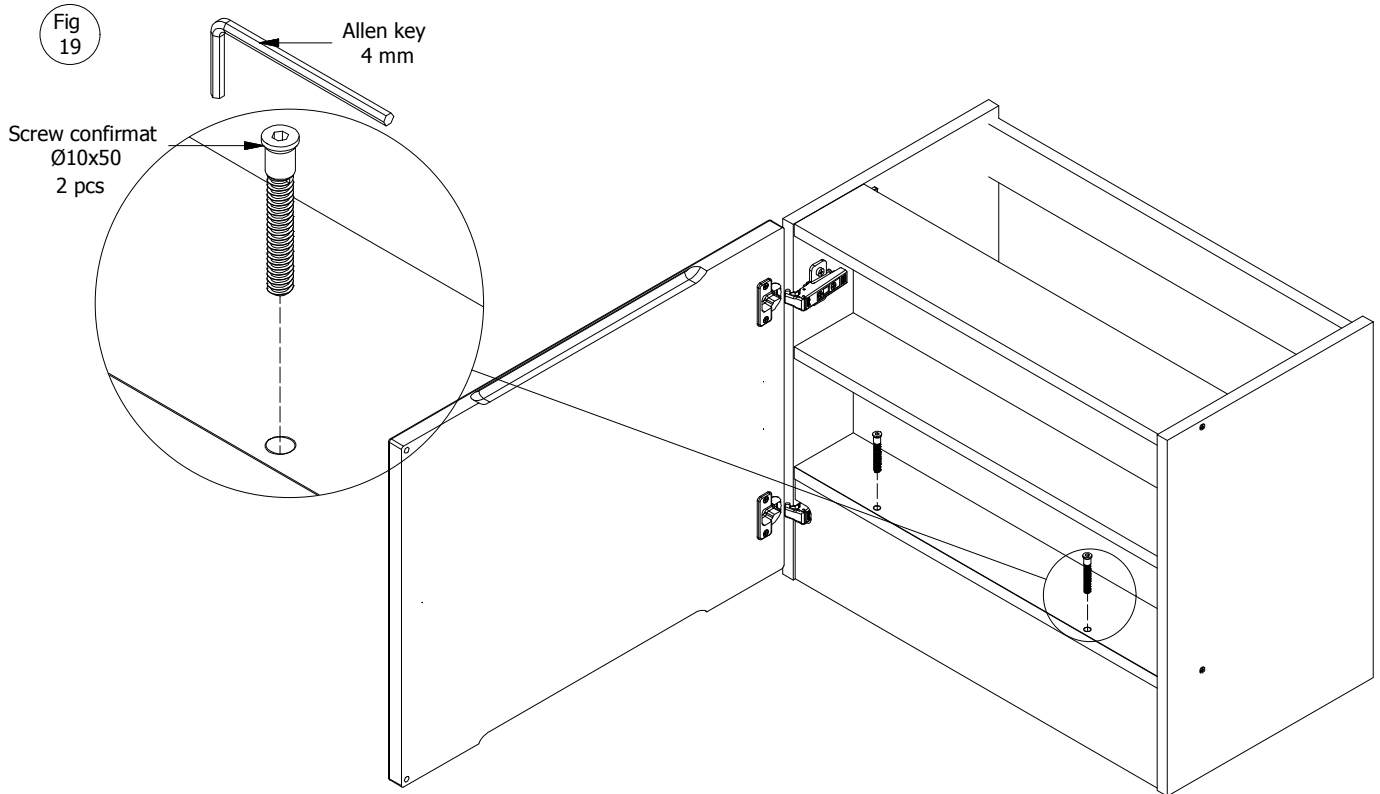

Fig 18





### Adjustment

